

INSTRUCTION MANUAL

with Catalog of Replacement Parts

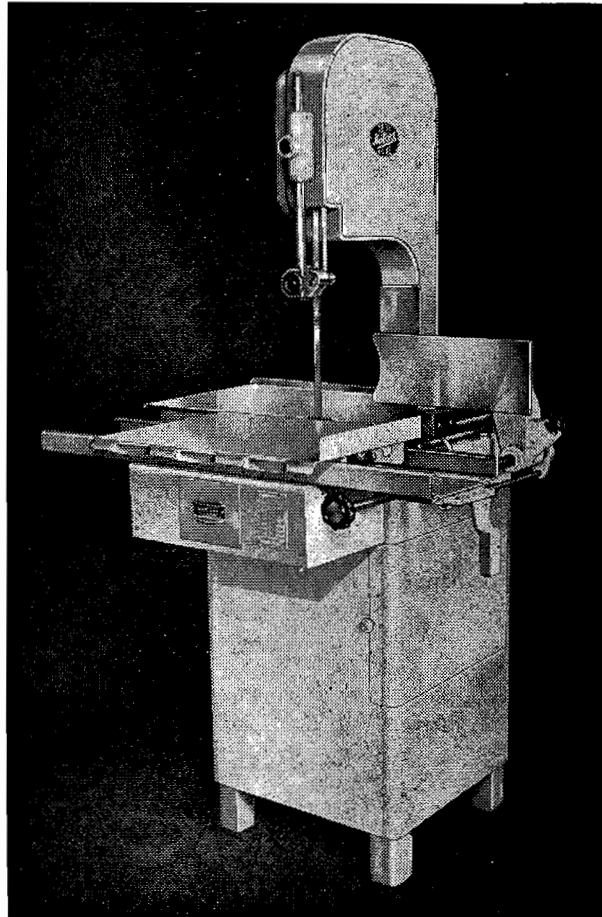

MODEL 5012 & 5012-D MEAT SAW

SPECIFICATION 7559 STANDARD
SPECIFICATION 7742 DELUXE



THE HOBART MANUFACTURING COMPANY

*The World's Oldest and Largest Manufacturer of Computing Scales and
Food Store, Kitchen, Bakery and Dishwashing Machines*

TROY, OHIO, U. S. A.

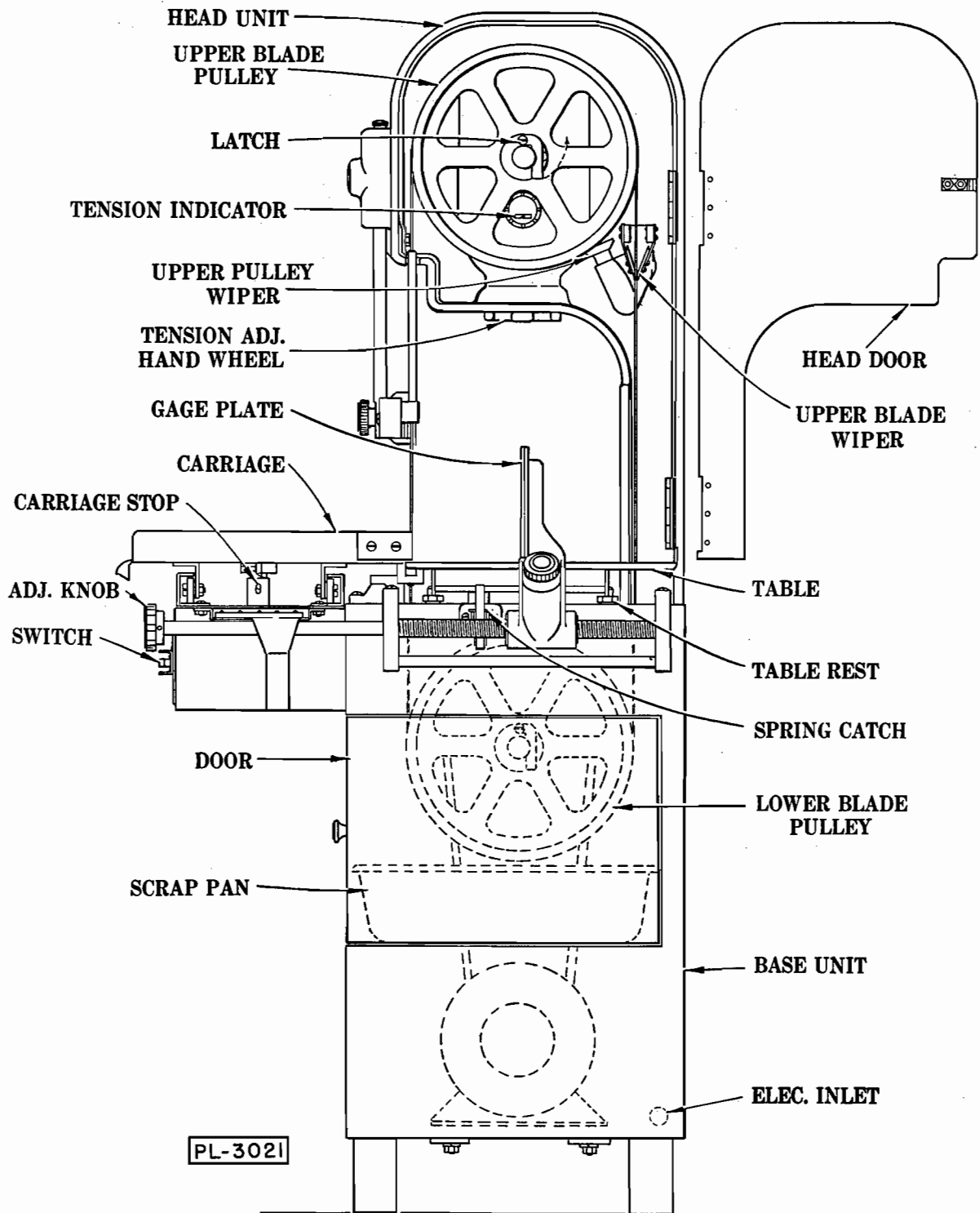

FIGURE 1

INSTRUCTIONS FOR MODEL 5012 & 5012-D MEAT SAW

I — UNPACKING

Having removed the shipping box that covers the saw, the first step is to detach the saw from the skids. It is fastened to the skids with four heavy bolts which must be removed from underneath, and it will therefore be necessary to tip the skid assembly to get at them. Discard the washers but **DO NOT LOSE THE BOLTS: SCREW THEM BACK INTO THE LEGS. THEY ARE TO BE USED AS LEVELING BOLTS.**

II — SETTING UP

(1) Move the machine to the location where it is to be used. Place a spirit level on top of the base unit and adjust the bolts in the legs so that the base unit is level from side to side, and back to back.

(2) Lower the upper blade pulley by giving the tension adjustment hand wheel (fig. 1) a few turns to the left, open door and swing the blade guard A (fig. 2) down to a horizontal position. Lift out lower wiper unit (fig. 3) and place the saw blade over the upper and lower blade pulleys (fig. 1). The teeth must point to the right and downward when viewed from the front as shown in fig. 3. If they do not point downward, remove the blade, twist inside out and replace it on the saw. Turn the tension adjustment hand wheel (fig. 1) to the right until the tension indicator reads "2". Give the upper pulley a few turns by hand so that the blade centers itself on the pulleys, then turn the tension adjustment handle slowly to the right until the indicator registers between "3" and "4". This is the best operating tension for the blade.

NOTE: See paragraph IX for adjustment of blade thrust rollers.

(3) Move the blade guard A (fig. 2) to the vertical position and close head door.

(4) Put in the lower wiper unit (fig. 3). Before sliding it into place, swing up the bakelite guard B and see that the saw blade is between the two wipers C and in the guide slot of steel block D. After sliding the unit into place, close down the bakelite guard B.

(5) To put on the table, swing gage plate E (fig. 4) to vertical position, clear of table area. Locate table into position by the locating block F (fig. 4), being sure the support angles on the underside of the table are inside the locating pins of the four table rests (fig. 1) on the base. Then lock in place by closing the spring catches (fig. 1) at each end.

(6) The carriage may be put on from either side. While rolling it into place, hold down the carriage stop (fig. 1). When the stop is released, it will prevent the carriage from rolling off.

III — WIRING

Before connecting to the power line, check the data on the name plate G (fig. 4) to make sure that the motor is correct for your electric service. Make your installation connection from the power line directly to the switch. In order to avoid having conduit at the front of the machine, it is recommended that flexible (or rigid) conduit be connected through the electric inlet hole in the base (fig. 1). The motor and switch are connected at the factory.

Be sure to use wire large enough to meet your local code requirements. For proper performance use wire sizes of **NOT LESS** than #10 gage for 115 V., or #14 gage for 230 V. on single phase models. Use #14 gage for 208, 220, and 440 V. on three phase models. For long runs, between power inlet and saw, use a larger size.

IV — SAFETY FEATURES

The Hobart Saw is provided with safety devices to give maximum protection to the operator. Keep the guards in place at all times.

(1) **UPPER GUIDE ASSEMBLY** (fig. 2). Keep as low as the size of the work permits.

(2) **UPPER GUARD A** (fig. 2). Keep in vertical position.

(3) **DOORS**. Keep doors closed when the machine is running.

(4) **BUTT-END PUSHER H** (fig. 4). Use this device as described in paragraph VI and it will be unnecessary to hold your hand near the running saw blade.

(5) **GAGE PLATE**. The end of the gage plate E (fig. 4) is shaped to give maximum support and protection at this critical point, and at the same time, facilitate the taking off of slices.

V — LUBRICATION

Very little lubrication is required, because all the high-speed shafts have roller or ball bearings which are grease-packed and will operate a long time without attention.

(1) Keep a small amount of grease in the four ball bearing rollers on the carriage.

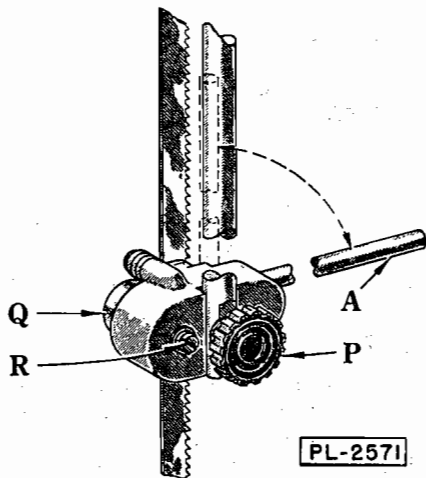

FIGURE 2
UPPER GUIDE ASSY.

(2) Apply a few drops of oil occasionally to the gage plate rack J (fig. 4) and work the gage plate assembly back and forth a few times.

(3) **IMPORTANT:** After each cleaning, use tasteless oil to lubricate the plunger of the upper pulley wiper (fig. 1) and the plunger K of the lower wiper L (fig. 3). Actuate these wipers to be sure they are lubricated properly, and will operate freely.

(4) Once a year, have a Hobart Service Man look over the motor and main bearing carriers.

VI — OPERATION

Place the item to be cut on the carriage and switch on the motor. Stand in front of the machine, leaning lightly against the scalloped front of the carriage and move the carriage to the left, past the saw blade, at a steady and uniform rate. Your left hand will then be free to take away and stack the items as they are cut off. Make it a habit to move your hand around the left side, or back of the saw blade, when reaching for an item - **NEVER IN FRONT OF THE TEETH.** On the return stroke, pull the item toward you so that it clears the saw blade.

The saw cuts through bone and meat alike, and no preliminary preparation with the butcher knife is necessary as with a hand saw.

When cutting slices of uniform thickness, set the gage plate at the desired point with adjusting knob M (fig. 4) on the scale etched on the table. If the gage plate is not needed and interferes with the work, it may be pushed out of the way. Lift the release knob N (fig. 4) and slide the gage plate on back to the end of rack J (fig. 4). The gage plate may be swung to a vertical position at any setting along the rack without lifting the release knob.

To slice short ends, use the pusher plate H (fig. 4) to hold the meat against the gage plate. A groove in the pusher slips over and slides along the up-turned edge of the carriage. Hold the pusher with your right hand as shown in fig. 4. Your hand will then always be a safe distance from the saw blade and the stop will prevent the pusher from going too far. When not using the pusher plate, keep it stored beneath the carriage track as shown in fig. 4, where provision has been made for holding it.

VII — CLEANING

It is very important that any appliance used in preparation of food be kept in a clean and sanitary condition. This machine has been designed to make cleaning a quick and easy job.

Daily cleaning is recommended.

SUGGESTED CLEANING PROCEDURE:

(1) Roll carriage to extreme right or left. This exposes the carriage stop. Depress carriage stop and roll off stainless steel carriage.

(2) Rotate gage plate to vertical position.

(3) Release spring catches and remove stainless steel table.

(4) Remove hand knob, open door and lift out upper blade wiper. Clean unit, then lubricate with **TASTELESS OIL.**

(5) Swing lower saw blade guard B (fig. 3) up and lift out lower wiper assembly. Clean unit thoroughly and **LUBRICATE WITH TASTELESS OIL.**

(6) Remove Scrap pan.

(7) Release blade tension by turning tension adjusting hand wheel to the left. Open head door and swing the upper blade guard down to horizontal position. Remove saw blade.

(8) To remove upper guide unit, loosen hand knob P (fig. 2) and remove unit. Clean, **LUBRICATE WITH TASTELESS OIL,** and replace.

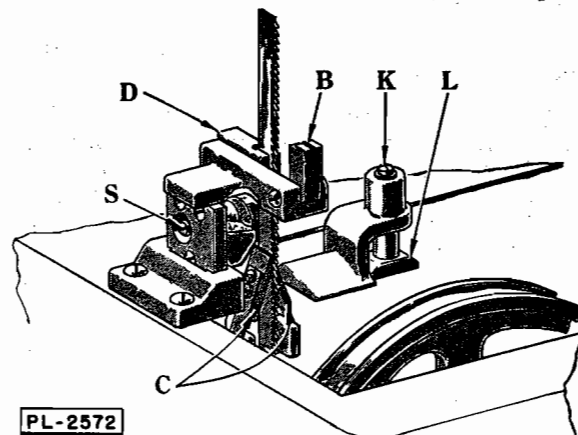

FIGURE 3
LOWER WIPER UNIT

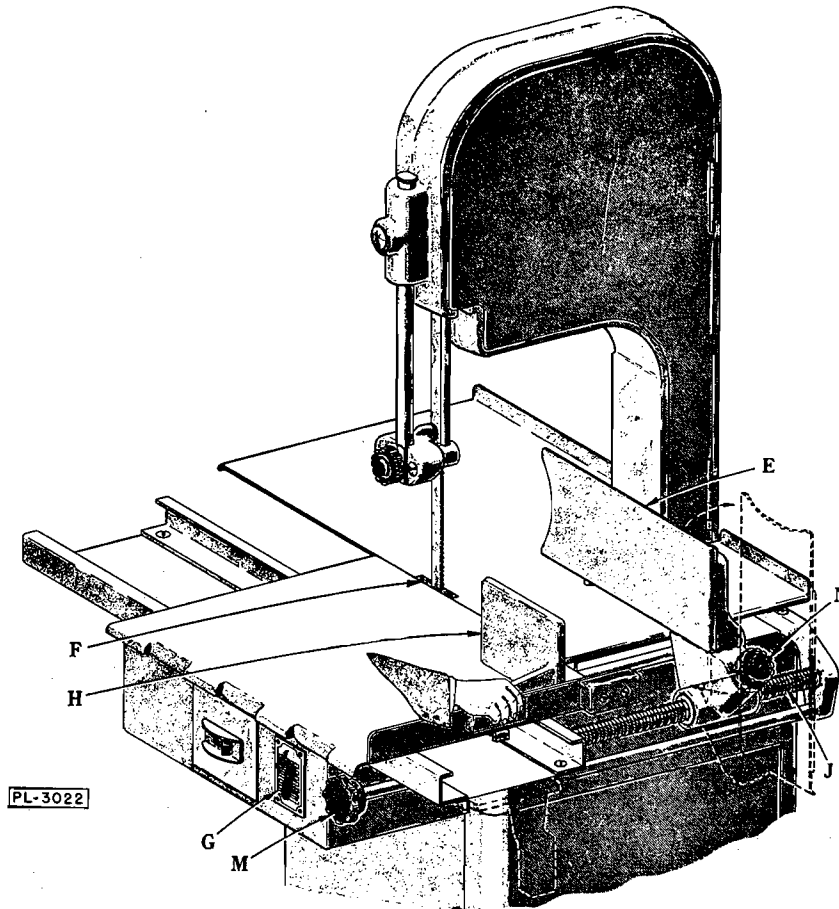

FIGURE 4

(9) Remove upper and lower pulleys by swinging the pulley retaining latches clear of the shafts. Slide pulleys off. Clean pulleys and oil bore before replacing.

All areas are now exposed for easy thorough cleaning.

NOTE: When replacing pulleys, make sure that pulley latches are properly seated in grooves of shaft. Also the blade and pulley wipers must be in proper operating positions.

VIII — CHANGING SAW BLADES

(1) Depress carriage stop and remove stainless steel carriage.

(2) Rotate gage plate to vertical position.

(3) Release Spring Catches and remove table.

(4) Lower upper blade pulley by turning tension adjusting hand wheel to left.

(5) Open head door and swing upper blade guard to horizontal position. Swing up lower blade guard and remove blade.

(6) Put on the new blade, turn the hand wheel to the right until the indicator reads "2", turn

the upper blade pulley (fig. 1) by hand to center the blade, and then turn the hand wheel until the indicator registers between "3" and "4". Now move the guard A (fig. 2) to the vertical position and insert the lower wiper unit. Make sure the upper blade wipers (fig. 1) are on both sides of blade.

IX - ADJUSTMENT OF BLADE THRUST ROLLERS

At the back edge of the saw blade in the upper guide and the lower wiper unit are ball bearing rollers which will take the cutting thrust. When the saw is running without load, the blade should not touch the rollers; the clearance being approx. 1/32 inch. Always check this after changing blades. Rollers should be adjusted to suit any variation in blade widths. IMPORTANT: Adjust the upper roller Q by turning the screw R (fig. 2) and the lower roller by turning screw S (fig. 3).

X — BLADE REPLACEMENT

Two saw blades are furnished as regular equipment with every machine. Replacement blades are available thru all Hobart offices.

HOBART REPLACEMENT PARTS

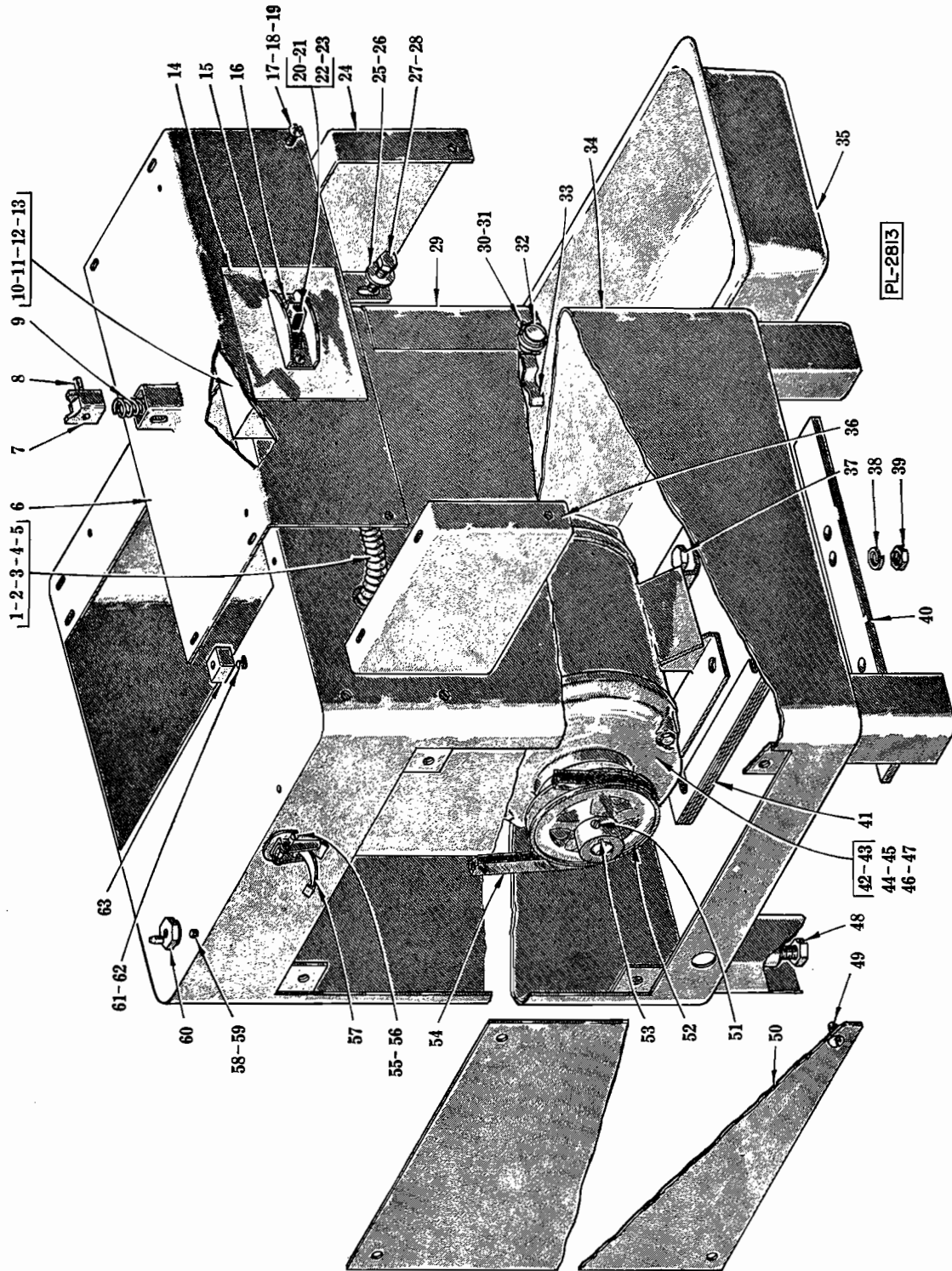

BASE & MAIN FRAME UNIT

HOBART REPLACEMENT PARTS

BASE & MAIN FRAME UNIT

ILLUS. PL-2813	PART NO.	NAME OF PART	AMT.
1	FE-6-38	Reducer - 3/4" to 1/2" Female Conduit -----	1
2	FE-6-6	Lock Nut - 3/4" Conduit -----	1
3	FE-2-17	Connector - 90° (1/2" x 1/2" Flex. Conduit) -----	2
4	P-24127-89	Conduit - 1/2" x 32" Flex. -----	1
5	BF-2-19	Bushing - 1/2" Anti-Short -----	2
6	S-67280	Base Cover Plate Assy. -----	1
7	M-23248	Stop - Carriage -----	1
8	RP-3-5	Rollpin - 1/4" Dia. x 2" Lg. -----	1
9	M-67317	Spring - Carriage Stop -----	1
10	P-67300	Switch Box Assy. -----	1
11	SC-9-28	Mach. Screw - #10-24 x 3/8" Rd. Hd. -----	2
12	WL-3-20	Lock Washer - #10 x .055" x .040" -----	2
13	NS-9-24	Mach. Nut - #10-24 Hex -----	2
14	P-67701	Plate - Switch Cover -----	1
15	M-14506-3	Shield - Switch -----	1
16	SC-9-44	Mach. Screw - #6-32 x 1/2" Rd. Hd. -----	2
17	SC-10-13	Mach. Screw - #10-24 x 3/8" Truss Hd. -----	2
18	WL-3-24	Lock Washer - #10 x .062" x .047" -----	2
19	NS-9-21	Mach. Nut - #10-24 Hex -----	2
20	SC-13-14	Mach. Screw - #6-32 x 3/8" Flat Hd. -----	2
21	R-24940-4	Switch (1 Phase Below 250 V.) -----	1
22	R-24940-2	Switch (2 & 3 Phase Below 250 V.) -----	1
23	SS-3-26	Switch (2 & 3 Phase Above 250 V.) -----	1
24	R-67284	Gusset - R.H. Track Support -----	1
25	WS-6-11	Washer -----	8
26	WL-4-2	Lock Washer - 3/8" x .136" x .070" -----	4
27	SC-36-54	Fin. Bolt - 3/8"-16 x 1" Hex Hd. -----	4
28	NS-13-22	Full Nut - 3/8"-16 Hex Fin. -----	4
29	R-67259	Base Door Assy. -----	1
30	SC-7-74	Mach. Screw - #10-24 x 3/8" Rd. Hd. -----	2
31	NS-9-21	Mach. Nut - #10-24 Hex -----	1
32	M-23274	Knob - Door -----	1
33	M-68176	Clip - Base Door Spring -----	1
34	T-67287	Base Assy. -----	1
35	R-67327	Pan - Meat Scrap -----	1
36	R-67285	Gusset - L.H. Track Support -----	1
37	SC-36-57	Fin. Bolt - 3/8"-16 x 1-1/4" Hex Hd. -----	4
38	WL-4-2	Lock Washer - 3/8" x .136" x .070" -----	4
39	NS-13-22	Full Nut - 3/8"-16 Hex Fin. -----	4
40	P-67593	Reinforcement - Base -----	2
41	M-67305	Booster - Motor -----	As Req'd.
42	S-67414-1	Motor - 1 Ph. 115/230 V. (60 Cy.) -----	1
43	S-67414-2	Motor - 1 Ph. 208 V. (60 Cy.) -----	1
44	S-67414-3	Motor - 1 ph. 120/240 V. (50 Cy.) -----	1
45	S-67415-1	Motor - 3 Ph. 208/220/440 V. (60 Cy.) -----	1
46	S-67415-2	Motor - 3 Ph. 550 V. (60 Cy.) -----	1
47	S-67415-3	Motor - 3 Ph. 220/380 V. (50 Cy.) -----	1
48	V-20991	Bolt - Leveling -----	4
49	SC-10-33	Mach. Screw - #10-24 x 1/2" Truss Hd. -----	4
50	S-67264	Panel - Motor Access -----	1
51	SC-47-31	Set Screw - 5/16"-18 x 5/16" Soc. Hdls. Kn. Cup Pt. -----	1
52	R-67309-1	"V" Pulley - Motor (4.80") (Incls. item #51) -----	1
53	R-12430-62	Key -----	1
54	BV-4-8	V-Belt -----	1
55	SC-10-33	Mach. Screw - #10-24 x 1/2" Truss Hd. -----	4
56	NS-31-12	Stop Nut - #10-24 "Elastic" -----	4
57	M-67319	Clamp - Table -----	2
58	SC-36-2	Fin. Bolt - 1/4"-20 x 1/2" Hex Hd. -----	4
59	WL-3-36	Lock Washer - 1/4" x .107" x .047" -----	4
60	M-67153	Table Rest Assy. -----	4
61	SC-36-4	Fin. Bolt - 1/4"-20 x 3/4" Hex Hd. -----	1
62	WL-3-36	Lock Washer - 1/4" x .107" x .047" -----	1
63	M-67145	Locator - Table -----	1
	SC-8-68	Mach. Screw - 1/4" - 20 x 1/2" Rd. Hd. (Retains item #9) (Not Shown) -----	2
	NS-13-1	Full Nut - 1/4"-20 Hex Fin. (Retains item #9) (Not Shown) -----	2
	WL-3-36	Lock Washer - 1/4" x .107" x .047" (Retains item #9) (Not Shown) -----	2

HOBART REPLACEMENT PARTS

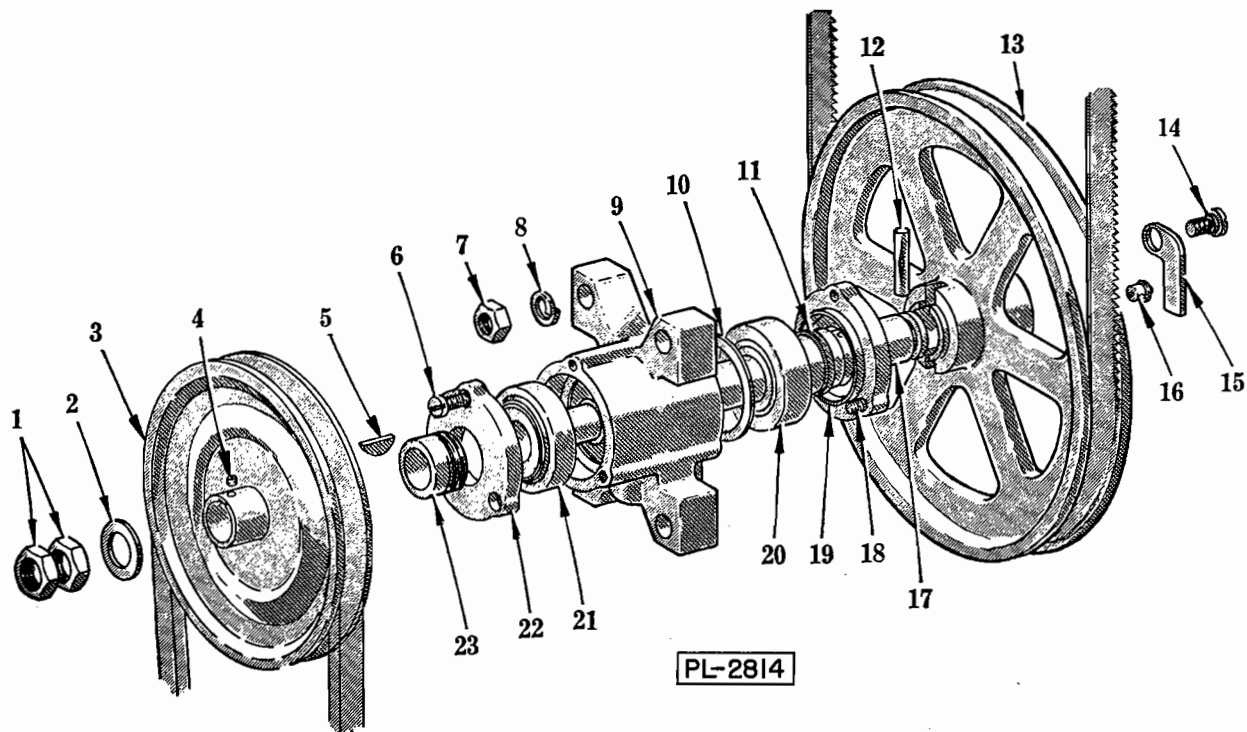

LOWER BEARING CARRIER UNIT

ILLUS. PL-2814	PART NO.	NAME OF PART	AMT.
1	NS-17-49	Jam Nut - 3/4"-16 Hex Fin. -----	2
2	WS-11-24	Washer -----	1
3	R-67308	"V" Pulley - Bearing Carrier (8") (Incls. item #4) -----	1
4	SC-46-50	Set Screw - 5/16"-18 x 1/4" Cup Pt. -----	1
5	KW-3-15	Key - #807 Woodruff -----	1
6	SC-12-69	Mach. Screw - 1/4"-20 x 1/2" Fil. Hd. -----	3
7	NS-13-30	Full Nut - 1/2"-13 Hex Fin. -----	8
8	WL-4-13	Lock Washer - 1/2" x .171" x .125" -----	8
9	R-67207	Carrier - Lower Bearing -----	1
10	RR-6-1	Retaining Ring -----	2
11	M-67307	Quad Ring -----	1
12	PG-7-23	Groov-Pin - Type #5, 5/16" x 1-3/4" -----	1
13	M-60294-3	Flanged Pulley (Blade) Sub-Assy. Unit (Incls. items #14, 15 & 16) -----	1
14	V-20851	Screw - Latch -----	1
15	M-20852	Latch -----	1
16	M-24114	Catch - #8-1/2 Frost -----	1
17	P-67242	Shaft - Lower Bearing Carrier -----	1
18	SC-12-69	Mach. Screw - 1/4"-20 x 1/2" Fil. Hd. -----	3
19	M-67870	Bearing Cap & Quad Ring Sub-Assy. (Incls. item #11) -----	1
20	BR-2-16	Roller Bearing -----	1
21	BR-2-16	Roller Bearing -----	1
22	P-67203	Cap - Bearing Carrier ("V" Belt Side) -----	1
23	M-67243	Conveyor - Lower Bearing Carrier Grease -----	1
	R-67871	Lower Bearing Carrier (Less Pulley) Sub-Assy. (Incls. items #6, 9, 10, 12, 17, 18, 19, 20, 21, 22 & 23) -----	1

HOBART REPLACEMENT PARTS

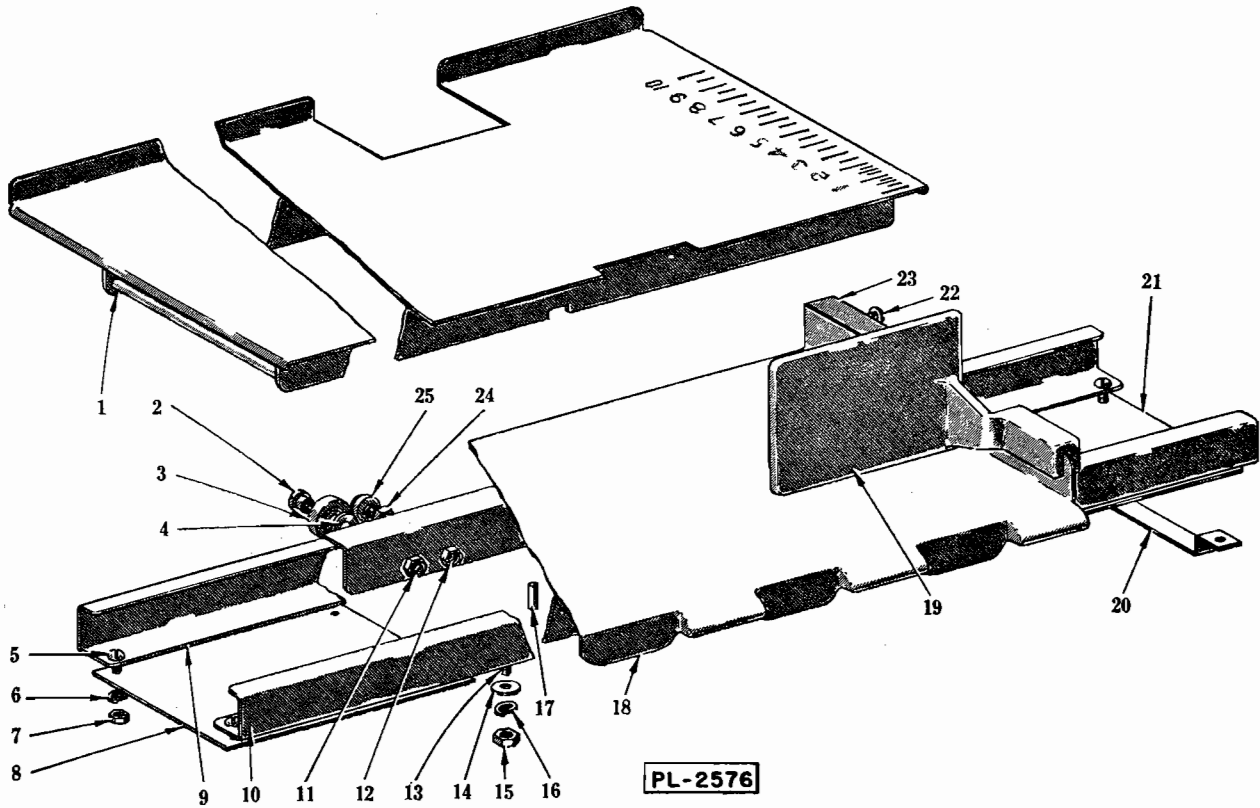

TABLE, TRACK & CARRIAGE UNIT

ILLUS. PL-2576	PART NO.	NAME OF PART	AMT.
1	S-67162	Table Assy. _____	1
2	V-20866	Screw - Roller Retaining _____	4
3	BB-8-2	Ball Bearing - Nice #400-24 _____	4
4	WS-4-25	Washer _____	4
5	SC-8-68	Mach. Screw - 1/4"-20 x 1/2" Rd. Hd. _____	8
6	WL-3-36	Lock Washer - 1/4" x .107" x .047" _____	8
7	NS-13-1	Full Nut - 1/4"-20 Hex Fin. _____	8
8	P-67252	Plate - L.H. Track End _____	1
9	R-67253	Track - Back _____	1
10	R-67254	Track - Front _____	1
11	NS-31-28	Stop Nut - 5/16"-18 "Elastic" Thin _____	4
12	NS-31-28	Stop Nut - 5/16"-18 "Elastic" Thin _____	2
13	SC-8-88	Mach. Screw - 5/16"-18 x 3/4" Rd. Hd. _____	4
14	WS-4-25	Washer _____	4
15	NS-13-11	Full Nut - 5/16"-18 Hex Fin. _____	4
16	WL-3-44	Lock Washer - 5/16" x .125" x .078" _____	4
17	PT-3-59	Taper Pin - #4 x 3/4" Lg. _____	2
18	T-67276	Carriage Sub. Assy. _____	1
19	R-67166	Plate - Pusher _____	1
20	P-67152	Support - Pusher Plate _____	1
21	P-67251	Plate - R.H. Track End _____	1
22	SC-10-33	Mach. Screw - #10-24 x 1/2" Truss Hd. _____	2
23	M-67181	Guard - Carriage _____	1
24	NS-17-8	Jam Nut - 5/16"-18 Hex Fin. _____	2
25	M-67245	Thrust Plug & Holder Assy. _____	2

HOBART REPLACEMENT PARTS

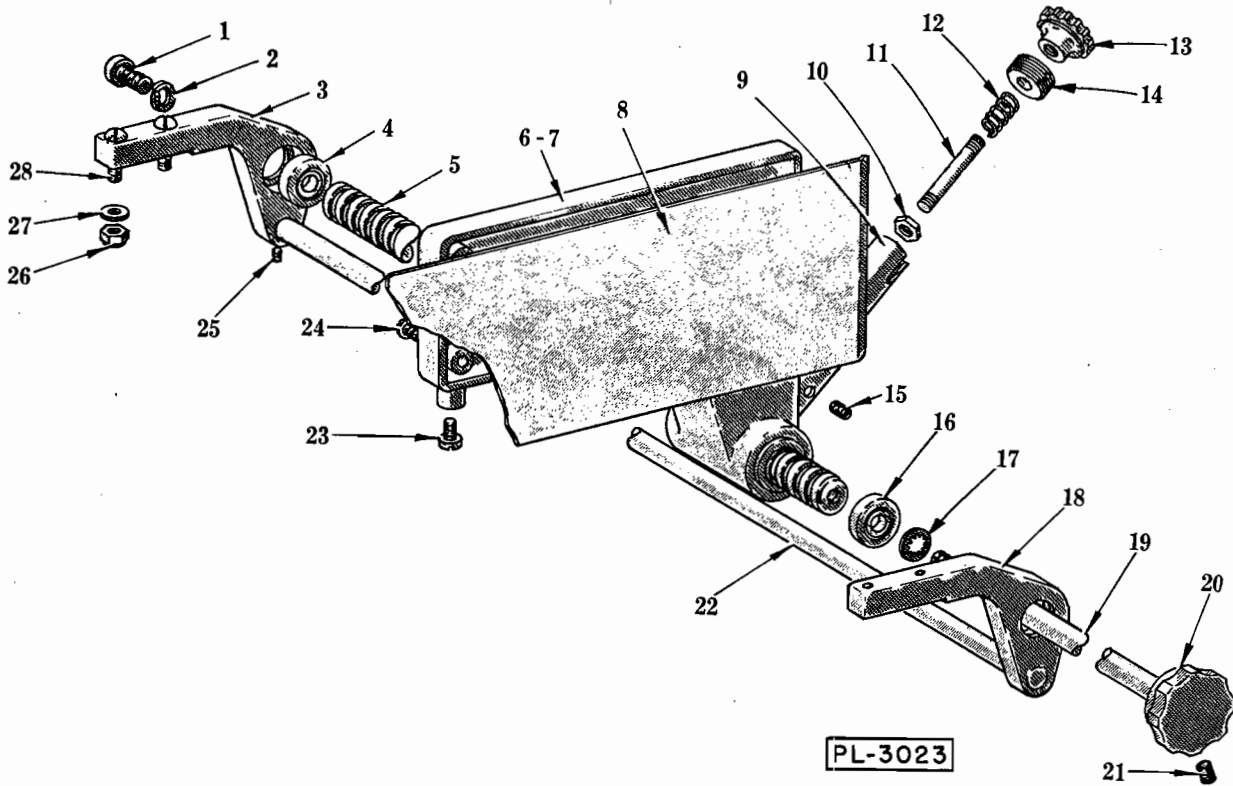

GAGE PLATE UNIT

ILLUS. NO.	PART NO.	NAME OF PART	AMT.
1	SC-40-70	Cap Screw - 3/8" - 16 x 1" Soc. Fil. Hd.	1
2	WL-4-2	Lock Washer - 3/8" x .136" x .070"	1
3	P-67172	Bracket - Gage Plate Rear Support	1
4	BB-8-2	Ball Bearing - Nice #400-24	1
5	P-67193	Screw - Gage Plate	1
6	P-67313-1	Gage Plate Support & Bushing Assy.	1
*7	P-67313-2	Gage Plate Support & Bushing Assy.	1
8	R-67247	Gage Plate & Weld Stud Assy.	1
9	M-69595	Half Nut - Gage Plate	1
10	NS-17-6	Jam Nut - 5/16"-18 Hex Fin.	1
11	M-67150	Stud - Gage Plate	1
12	V-7433-2	Spring	1
13	M-67315	Knob	1
14	M-67191	Retainer - Gage Plate Half Nut	1
15	SC-63-26	Set Screw - 1/4"-20 x 1/4" Flat Pt.	2
16	BB-8-2	Ball Bearing - Nice #400-24	1
17	WL-8-26	Lock Washer - 3/8" Int. Shakeproof	1
18	P-67173	Bracket - Gage Plate Front Support	1
19	P-67188	Shaft - Extension	1
20	M-67316	Knob - Gage Plate Adjusting (Incls. item #21)	1
21	SC-47-15	Set Screw - 1/4"-20 x 1/2" Soc. Hdls. Kn. Cup Pt.	1
22	M-67211	Rod - Gage Plate Stop	1
23	M-67314	Mach. Screw - Gage Plate, Nylon	1
24	SC-10-33	Mach. Screw - #10-24 x 1/2" Truss Hd.	3
25	SC-47-9	Set Screw - 1/4"-20 x 1/4" Soc. Hdls. Kn. Cup Pt.	2
26	NS-31-17	Stop Nut - 1/4"-20 "Elastic"	4
27	WS-3-23	Washer	4
28	SC-8-76	Mach. Screw - 1/4"-20 x 1-3/8" Rd. Hd.	4
	S-67170-1	Gage Plate Sub-Assy. (Incls. items #6, 8, 9, 10, 11, 12, 13, 14, 15, 23 & 24)	1
	*S-67170-2	Gage Plate Sub-Assy. (Incls. items #7, 8, 9, 10, 11, 12, 13, 14, 15, 23 & 24)	1

* FOR DELUXE MODEL ONLY

HOBART REPLACEMENT PARTS

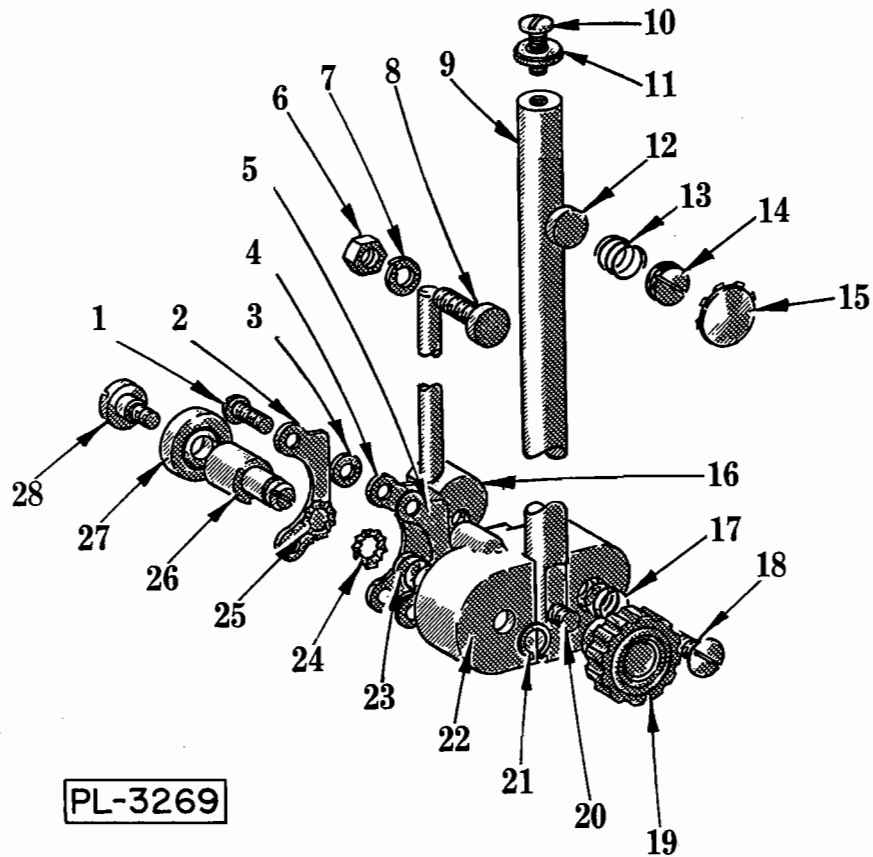

UPPER GUIDE UNIT

ILLUS. NO.	PART NO.	NAME OF PART	AMT.
1	SC-10-36	Mach. Screw - #10-24 x 5/8" Truss Hd. -----	2
2	M-67182	Guide - Blade -----	1
3	M-67233	Spacer - Blade Guide -----	2
4	M-67182	Guide - Blade -----	1
5	M-67655	Shim - Upper Guide Support -----	As Req'd.
6	NS-17-20	Jam Nut - 3/8"-24 Hex Fin. -----	1
7	WL-4-2	Lock Washer - 3/8" x .136" x .070" -----	1
8	M-67237	Screw - Slide Rod Adjusting -----	1
9	P-69846	Rod - Slide -----	1
10	SC-53-16	Mach. Screw - 5/16"-18 x 5/8" Truss Hd. -----	1
11	M-69849	Stop - Slide Rod -----	1
12	M-67239	Shoe - Slide Rod -----	1
13	V-12734	Spring -----	1
14	M-67427	Set Screw - Upper Guide -----	1
15	PE-2-26	Plug Button -----	1
16	M-67198	Upper Guide Guard & Support Assy. -----	1
17	V-20963	Spring - Blade Guard -----	1
18	M-67843	Screw - Special Truss Hd. -----	1
19	M-67315	Knob -----	1
20	V-21158	Stud - Upper Guide Support -----	1
21	RR-4-4	Retaining Ring -----	1
22	R-67197	Support - Upper Guide -----	1
23	V-23326	Spring - Adj. Blade Guide -----	1
24	M-23275	Washer - Lock Adj. Blade (Stat.) -----	1
25	M-23328	Washer - Lock Adj. Blade (Rot.) -----	1
26	M-67183	Shaft - Upper Guide Support -----	1
27	BB-17-35	Ball Bearing - N.D. #77501 -----	1
28	V-20840	Screw - Bearing Retaining -----	1
	P-67196-1	Upper guide Assy. (Incls. items #1, 2, 3, 4, 5, 16, 17, 18, 20, 21, 22, 23, 24, 25, 26, 27 & 28) -----	1

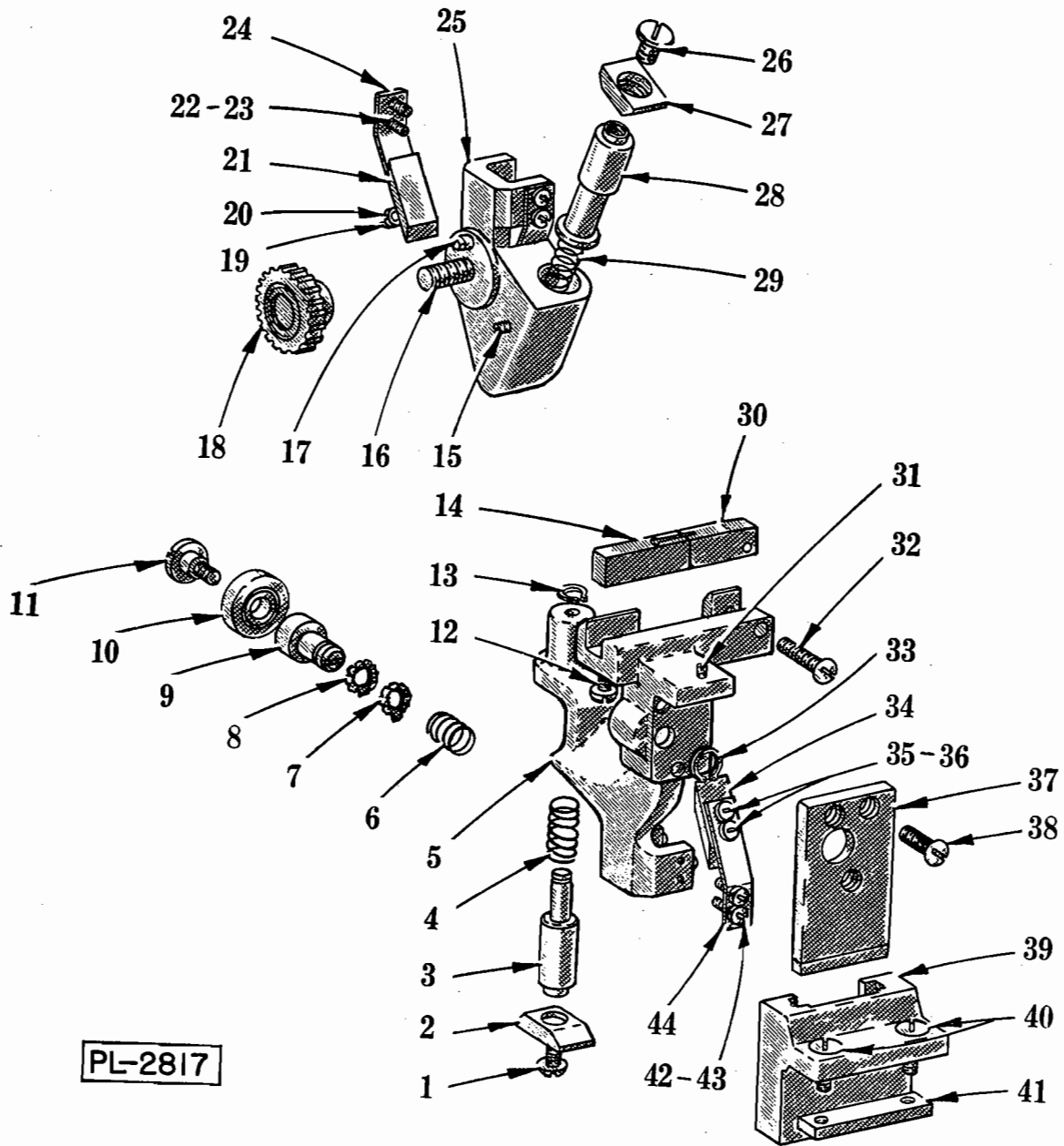

UPPER & LOWER WIPER AND GUIDE UNIT

HOBART REPLACEMENT PARTS

UPPER & LOWER WIPER AND GUIDE UNIT

ILLUS. PL-2817	PART NO.	NAME OF PART	AMT.
1	SC-53-9	Mach. Screw - 1/4"-28 x 1/2" Truss Hd. -----	1
2	M-22027	Wiper - Blade Pulley -----	1
3	V-20837	Plunger - Blade Pulley Wiper -----	1
4	V-7433-2	Spring - Blade Pulley Wiper -----	1
5	S-67155	Bracket - Lower Wiper -----	1
6	V-23326	Spring - Adj. Blade Guide -----	1
7	M-23275	Washer - Lock Adj. Blade (Stat.) -----	1
8	M-23328	Washer - Lock Adj. Blade (Rot.) -----	1
9	M-23236	Shaft - Adj. Blade Guide -----	1
10	BB-17-35	Ball Bearing - N.D. #77501 -----	1
11	V-20840	Screw - Bearing Retainer -----	1
12	SC-11-48	Mach. Screw - #10-24 x 5/8" Fil. Hd. -----	2
13	RR-4-2	Retaining Ring -----	1
14	M-68541	Guide - Saw Blade -----	1
15	SC-63-21	Set Screw - #10-24 x 5/16" Flat Pt. -----	2
16	V-21158	Stud - Upper Guide Support -----	1
17	M-67306	Pin - Table Rest -----	1
18	M-67315	Knob -----	1
19	SC-21-85	Mach. Screw - #8-32 x 3/16" Rd. Hd. -----	4
20	WL-6-1	Lock Washer - #8 x .047" x .031" -----	4
21	M-67184	Scraper - Blade -----	2
22	SC-21-14	Mach. Screw - #8-32 x 3/8" Rd. Hd. -----	4
23	WL-6-1	Lock Washer - #8 x .047" x .031" -----	4
24	M-67185	Spring - Blade Scraper -----	2
25	R-67157	Bracket - Upper Wiper -----	1
26	SC-53-9	Mach. Screw - 1/4"-28 x 1/2" Truss Hd. -----	1
27	M-22027	Wiper - Blade Pulley -----	1
28	M-23269	Plunger - Blade Pulley Wiper -----	1
29	M-23325	Spring - Blade Pulley Wiper -----	1
30	V-20865	Guard - Saw Blade -----	1
31	SC-46-17	Set Screw - #10-24 x 3/8" Flat Pt. -----	1
32	SC-9-55	Mach. Screw - #10-24 x 1-1/4" Rd. Hd. -----	1
33	RR-4-4	Retaining Ring -----	1
34	M-67184	Scraper - Blade -----	2
35	SC-21-85	Mach. Screw - #8-32 x 3/16" Rd. Hd. -----	4
36	WL-6-1	Lock Washer - #8 x .047" x .031" -----	4
37	M-67186	Slide - Lower Wiper Bracket -----	1
38	SC-12-69	Mach. Screw - 1/4"-20 x 1/2" Fil. Hd. -----	3
39	P-67189	Slideway - Wiper Bracket -----	1
40	SC-8-92	Mach. Screw - 5/16"-18 x 1" Rd. Hd. -----	2
41	M-67702	Plate - Wiper Bracket Retainer -----	1
42	SC-21-14	Mach. Screw - #8-32 x 3/8" Rd. Hd. -----	4
43	WL-6-1	Lock Washer - #8 x .047" x .031" -----	4
44	M-67185	Spring - Blade Scraper -----	2
	S-67156	Lower Wiper Assy. (Incls. items #1, 2, 3, 4, 5, 6, 7, 8, 9, 10, 11, 12, 13, 14, 30, 31, 32, 33, 34, 35, 36, 37, 38, 42, 43 & 44) -----	1
	R-67158	Upper Wiper Assy. (Incls. items #15, 16, 17, 19, 20, 21, 22, 23, 24, 25, 26, 27, 28 & 29) -----	1

HOBART REPLACEMENT PARTS

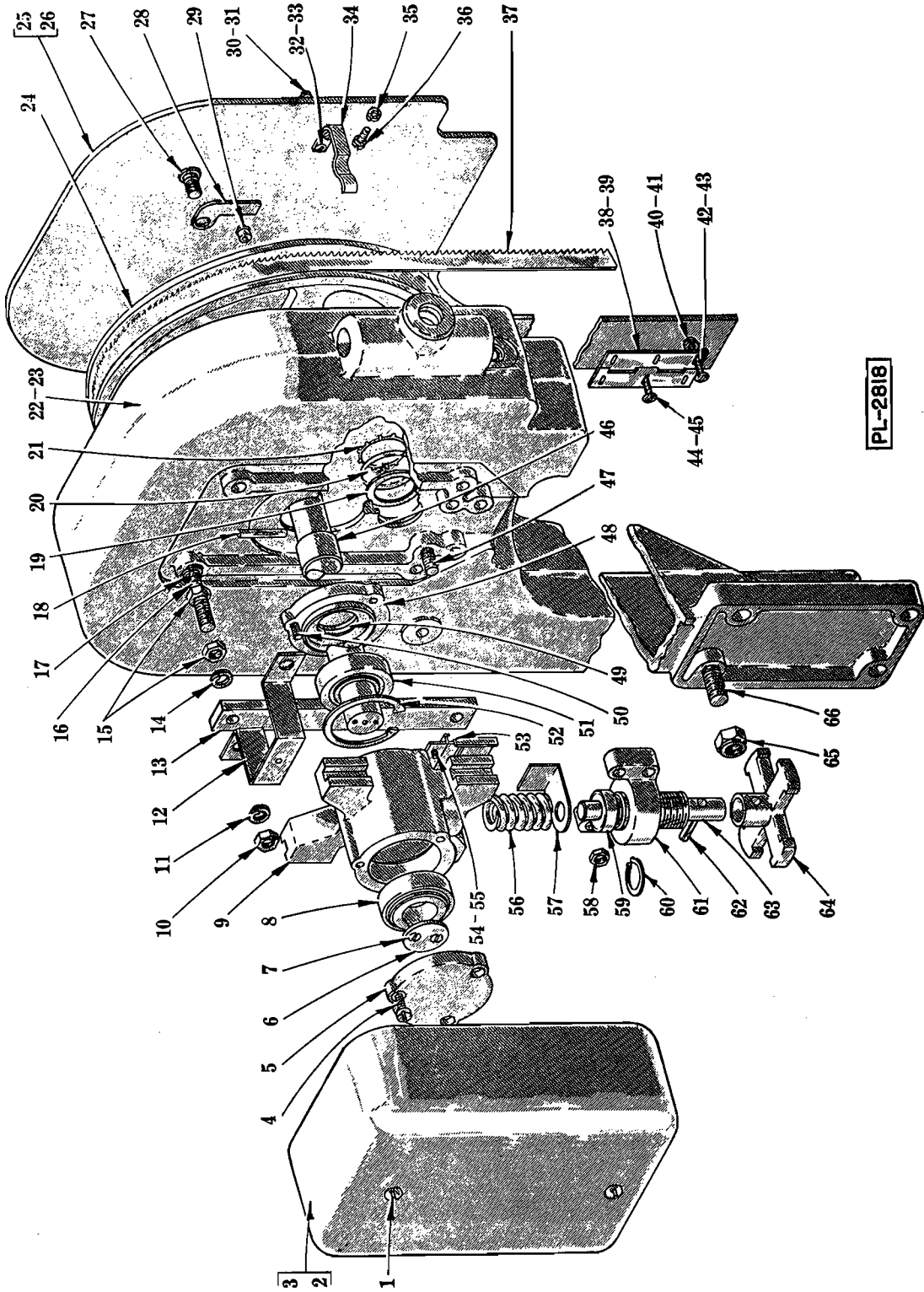

PL-2818

HEAD UNIT

HOBART REPLACEMENT PARTS

HEAD UNIT

ILLUS. PART PL-2818 NO.	NAME OF PART	AMT.
1	SC-10-39 Mach. Screw - #10-24 x 1" Truss Hd. -----	2
2	R-67151-1 Cover - Upper Bearing Carrier -----	1
*3	R-67151-2 Cover - Upper Bearing Carrier -----	1
4	SC-12-69 Mach. Screw - 1/4"-20 x 1/2" Fil. Hd. -----	3
5	P-67210 Cap - Bearing Carrier -----	1
6	M-67241 Retainer - Upper Bearing -----	1
7	SC-13-46 Mach. Screw - #10-24 x 1/2" Flat Hd. -----	2
8	BR-2-16 Roller Bearing -----	1
9	R-67205 Carrier - Upper Bearing -----	1
10	NS-13-22 Full Nut - 3/8"-16 Hex Fin. -----	4
11	WL-4-2 Lock Washer - 3/8" x .136" x .070" -----	4
12	P-67147 Cover Bracket & Weld Nut Assy. -----	2
13	P-67187 Gib - Upper Bearing Carrier -----	2
14	WL-4-2 Lock Washer - 3/8" x .136" x .070" -----	4
15	NS-13-22 Full Nut - 3/8"-16 Hex Fin. -----	8
16	M-68139 Support Screw - Upper Bearing Carrier -----	4
17	WL-4-2 Lock Washer - 3/8" x .136" x .070" -----	4
18	PG-7-23 Groove-Pin - Type #5, 5/16" x 1-3/4" -----	1
19	V-20898 Gasket - Indicator Lens -----	1
20	V-20889 Lens - Indicator -----	1
21	M-23335 Ring - Lens Retaining -----	1
22	T-67154-1 Head -----	1
*23	T-67154-2 Head -----	1
24	M-60294-3 Flanged Pulley (Blade) Sub-Assy. Unit (Incls. items #27, 28 & 29) -----	1
25	R-67246-1 Door - Head -----	1
*26	R-67246-2 Door - Head -----	1
27	V-20851 Screw - Latch -----	1
28	M-20852 Latch -----	1
29	M-24114 Catch - #8-1/2 Frost -----	1
30	NS-24-14 Acorn Nut - #10-24 -----	2
*31	NS-27-2 Acorn Nut - #10-24 -----	2
32	SC-10-13 Mach. Screw - #10-24 x 3/8" Truss Hd. -----	2
*33	SC-53-5 Mach. Screw - #10-24 x 3/8" Truss Hd. -----	2
34	M-67180 Clip - Head Door Spring -----	1
35	WL-3-35 Lock Washer - 1/4" x .047" x .078" -----	1
36	SC-8-68 Mach. Screw - 1/4"-20 x 1/2" Rd. Hd. -----	1
37	P-67447 Blade - Meat Saw -----	1
38	M-23271-1 Hinge - Door to Head -----	2
*39	M-23271-2 Hinge - Door to Head -----	2
40	NS-24-14 Acorn Nut - #10-24 -----	12
*41	NS-27-2 Acorn Nut - #10-24 -----	12
42	SC-10-13 Mach. Screw - #10-24 x 3/8" Truss Hd. -----	6
*43	SC-53-5 Mach. Screw - #10-24 x 3/8" Truss Hd. -----	6
44	SC-10-43 Mach. Screw - #10-24 x 3/4" Truss Hd. -----	6
*45	SC-53-3 Mach. Screw - #10-24 x 3/4" Truss Hd. -----	6
46	P-67244 Shaft - Upper Bearing Carrier -----	1
47	SC-10-38 Mach. Screw - 5/16"-18 x 1-3/4" Truss Hd. -----	4
48	M-67870 Bearing Cap & Quad Ring Sub-Assy. (Incls. item #49) -----	1
49	M-67307 Quad Ring -----	1
50	SC-12-69 Mach. Screw - 1/4"-20 x 1/2" Fil. Hd. -----	3
51	BR-2-16 Roller Bearing -----	1
52	RR-6-1 Retaining Ring -----	2
53	P-67249 Plate - Blade Tension Sight -----	1
54	SC-7-74 Mach. Screw - #10-24 x 3/8" Rd. Hd. -----	2
55	WL-3-20 Lock Washer - #10 x .055" x .040" -----	2
56	M-20867 Spring - Adj. Blade Tension -----	1
57	M-67250 Indicator - Tension -----	1
58	NS-17-6 Jam Nut - 5/16"-18 Hex Fin. -----	2
59	BB-13-1 Ball Bearing - Nise #603 -----	1
60	RR-4-8 Retaining Ring -----	1
61	P-67204 Nut - Blade Tension Adjusting -----	1
62	RP-2-17 Rollpin - 1/4" Dia. x 1" Lg. -----	1
63	M-67240 Screw - Blade Tension Adjusting -----	1
64	P-67190 Wheel - Hand -----	1
65	NS-31-37 Stop Nut - 1/2"-13 "Elastic" -----	4
66	SC-40-34 Cap Screw - 1/2"-13 x 1-1/4" Soc. Fil. Hd. -----	4
	R-67206 Upper Bearing Carrier Assy. (Incls. items #4, 5, 6, 7, 8, 9, 18, 46, 48, 50, 51 & 52) -----	1

* FOR DELUXE MODEL ONLY

MACHINE SHIPPED WITH CARRIAGE
TABLE AND TRACKS REMOVED
WILL PASS THROUGH 26" OPENING

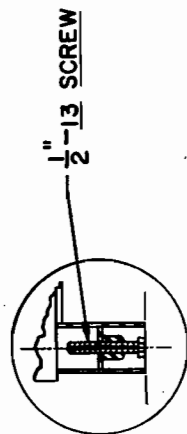

ENLARGED VIEW OF LEG
SHOWING ADJUSTING SCREW

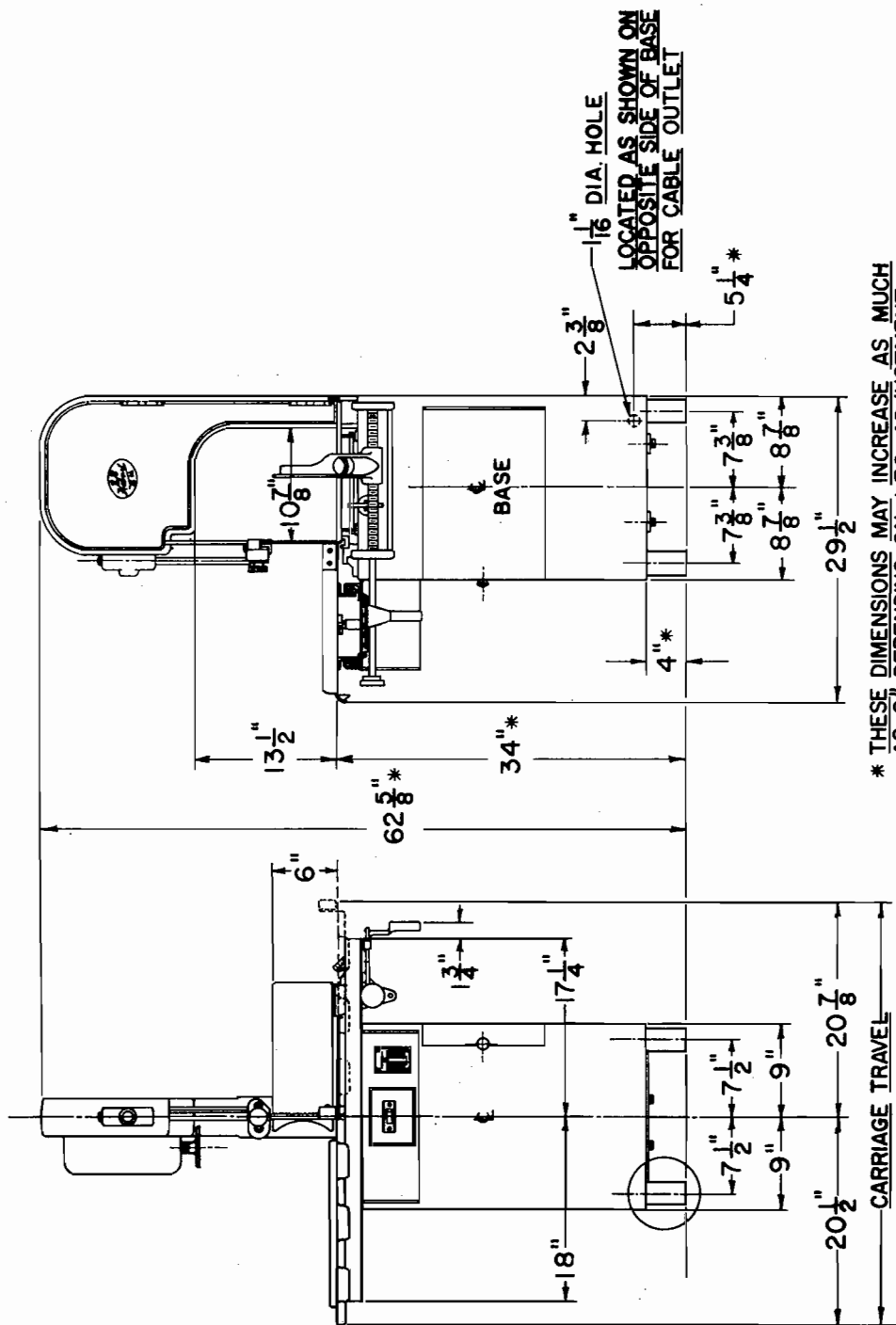

* THESE DIMENSIONS MAY INCREASE AS MUCH
AS 2", DEPENDING ON LEG ADJUSTMENT

PL-3025

R-67642

INSTALLATION DIAGRAM