

INSTRUCTION MANUAL

with Catalog of Replacement Parts

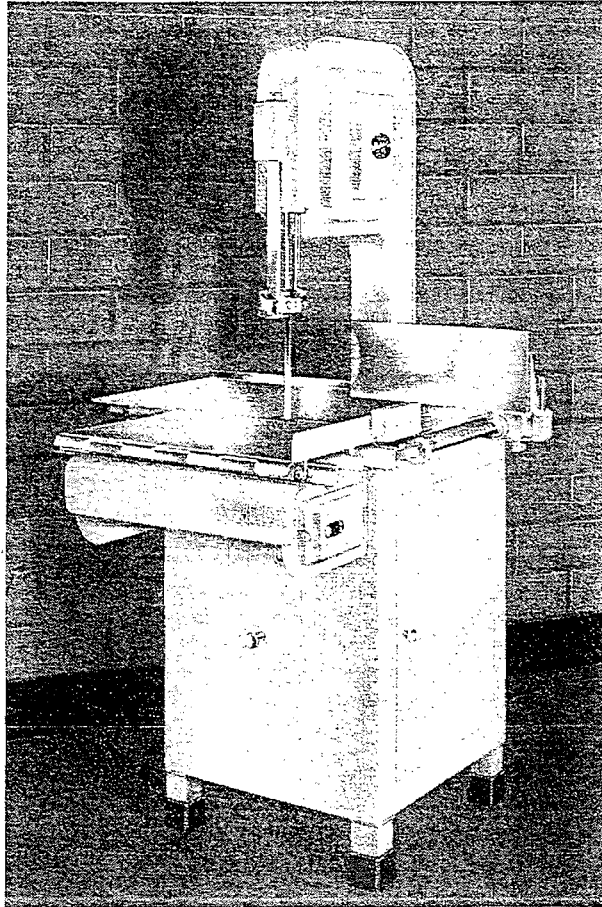

MODEL 5213 MEAT SAW

Specification No. 4864 - A. C.

Specification No. 4876 - D. C.

(And Model 5313, Specification No. 4865)

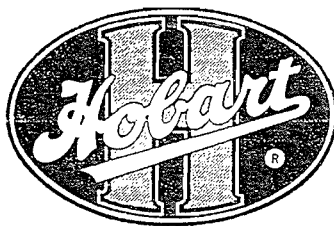

THE HOBART MANUFACTURING CO.
TROY, OHIO, U. S. A.

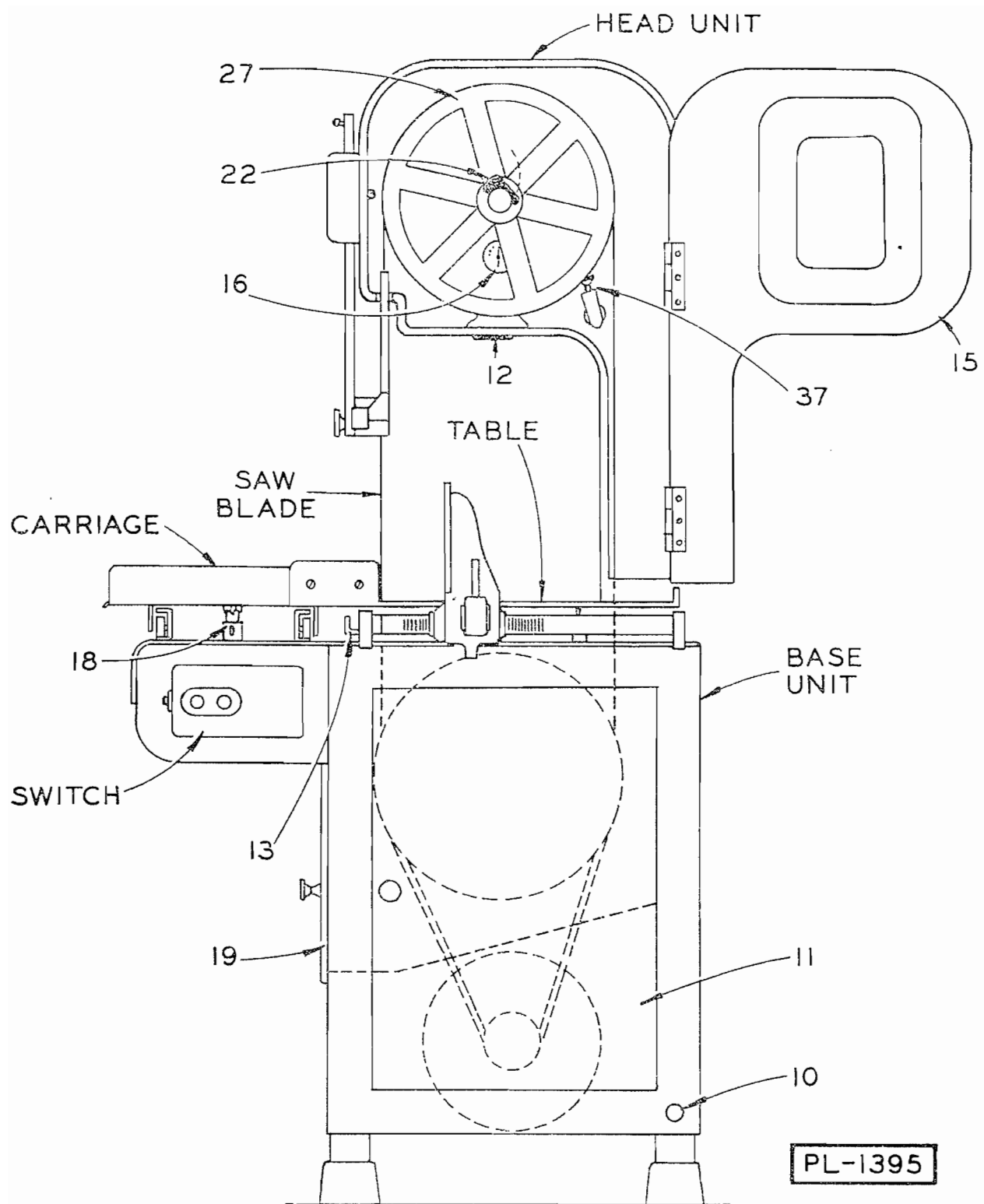

FIGURE 1

Instructions for Model 5213 Meat Saw

(The same instructions apply to Model 5313 which is similar but has a 1½ h.p. motor.)

I - UNPACKING

Having removed the shipping box that covers the base unit, the first step is to detach the unit from the skids or base timbers. It is fastened down with four heavy bolts which must be removed from underneath, and it will therefore be necessary to tip the skid assembly to get at them. Discard the washers but **DO NOT LOSE THE BOLTS; SCREW THEM BACK INTO THE LEGS. THEY ARE TO BE USED AS LEVELING BOLTS.**

II - SETTING UP

(1) Move the machine to the location where it is to be used. Place a spirit level on top of the base unit and adjust the bolts in the legs to suit an uneven floor. The sleeves may be pushed up out of the way while turning the

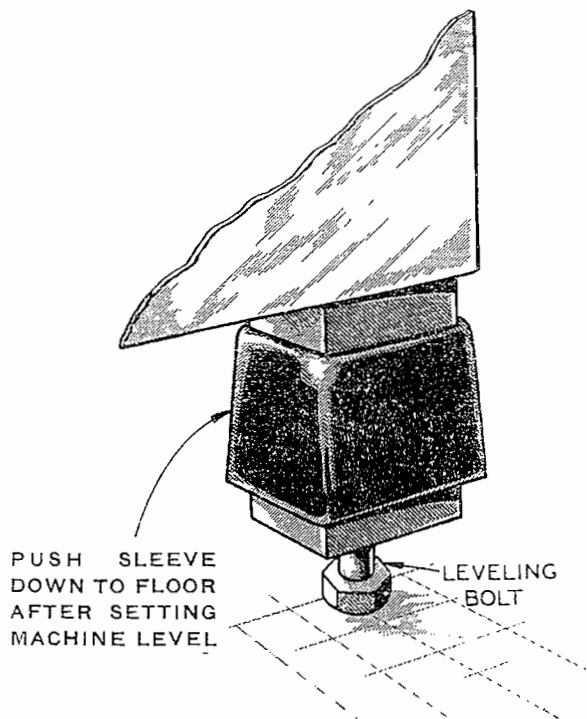

FIGURE 2

leveling bolts, (as shown in fig. 2) and, when all four have been adjusted, push the sleeves down in contact with the floor to prevent the entrance of dirt.

(2) Lower the upper blade pulley by giving the tension adjustment handle 12 (fig. 1) a few turns to the left, swing the guard 17 (fig. 3) down to a horizontal position, and put on a saw blade. The teeth must point to the right and downward when viewed from the front as shown in fig. 6. Turn the tension adjustment handle 12 (fig. 1) to the right until the indicator reads "2". Give the upper pulley 27 a few turns by hand so that the blade centers itself on the pulleys, then turn the tension adjustment handle slowly to the right until the indicator 16 registers between "3" and "4".

(3) Move the guard 17 (fig. 3) to the vertical position. As this is done, the slot in the bakelite block attached to the guard will straddle the saw blade.

(4) Put in the lower wiper unit (fig. 4). Before sliding it into place swing up the bakelite guard 21 and see that the saw blade is between the two wipers 20 and in the guide slot of the steel block 36. After sliding the unit into place, close down the bakelite guard 21.

(5) Put on the table. Squeeze the latch K (fig. 5) and move the gage plate assembly back as far as it will go, then swing it up out of the way. Catches on the underside of the table will engage mating parts on the base, after which the table can be secured by moving the locking handle 13 (fig. 1) to the right. Be sure that the ribs on the table are inside the lugs on the base.

(6) Put on the carriage. While rolling it into place hold down the plunger 18 (fig. 1). When the plunger is released, stops on top of it will prevent the carriage from rolling off.

III - WIRING

Before connecting to the power line, check the data on the name plate to make sure that the motor is correct for your electric service. The name plate is at N (fig. 6). Connections are already made between the motor and the starting switch, leaving only the connection between the switch and the power lines to be made at installation. Flexible or rigid conduit is recom-

mended for the purpose and a hole 10 (fig. 1) is provided in the base for its entrance. The switch is of the pushbutton type and has thermal overload protection.

A wiring diagram of the switch is attached to the inside of the cover. Be sure to use wire large enough to meet your local code requirements. For long runs, use a larger size.

IV - SAFETY FEATURES

Any edged tool can be a source of danger if not handled properly. This is true even of a butcher knife. The Hobart Saw is provided with safety devices to give maximum protection to the operator. Keep the guards in place at all times.

(1) UPPER GUIDE ASSEMBLY (fig. 3) Keep as low as the size of the work permits.

(2) UPPER GUARD 17 (fig. 3) Keep folded up in front of the saw blade.

(3) SAW BLADE The blade must be neither too tight nor too loose. A setting of "3" to "4" is recommended.

(4) DOORS Keep all doors closed when the machine is running.

(5) BUTT-END PUSHER 30 (fig. 5) Use this device as described in paragraph VI and it will be unnecessary to hold your hand near the running saw blade.

(6) GAGE PLATE The end of the gage plate at 32 (fig. 5) is shaped to give maximum support and protection at this critical point and, at the same time, facilitate the taking off of slices.

V - LUBRICATION

Very little lubrication is required because all the high-speed shafts have ball bearings which are grease-packed and will go a long time without attention.

(1) Keep a small amount of grease in the six ball bearing rollers on the carriage.

(2) Apply a few drops of oil occasionally to the gage plate rack 33 (fig. 5) and work the gage plate assembly back and forth a few times.

(3) Once a week, put a drop or two of oil on the upper and lower pulley wiper plungers 37 (figs. 4 and 1) and the holders to which the two wipers 20 (fig. 4) are attached.

(4) Once a year have a Hobart Service Man look over the motor and main bearing carriers. He will take out the plugs and inject the correct amount of ball bearing grease.

(5) After washing, oil where necessary.

VI - OPERATION

Place the piece of meat on the carriage and switch on the motor. Stand in front of the machine leaning lightly against the scalloped side of the carriage and move the carriage to the left, past the saw blade, at a steady and uniform rate. Be careful not to cause the saw blade to twist, but hold the meat firmly and cut straight. Rest your right hand upon the meat and use your body to help move the carriage. Your left hand will then be free to take away the pieces of meat as they are cut off. Make it a habit to move your hand around the left side, or back of the saw blade, when reaching for a piece of meat — never in front of the teeth. On the return stroke, pull the meat toward you a little so that it does not drag past the saw blade.

The saw cuts through bone and meat alike and no preliminary preparation with the butcher knife is necessary as with a hand saw.

When cutting slices of uniform thickness, set the gage plate at the desired point on the scale etched on the table. If the gage plate is not needed and interferes with the work, it may be pushed out of the way. Squeeze the latch and slide it on back to the end of rack 33 (fig. 5). Be sure to squeeze the latch before trying to swing up the gage plate.

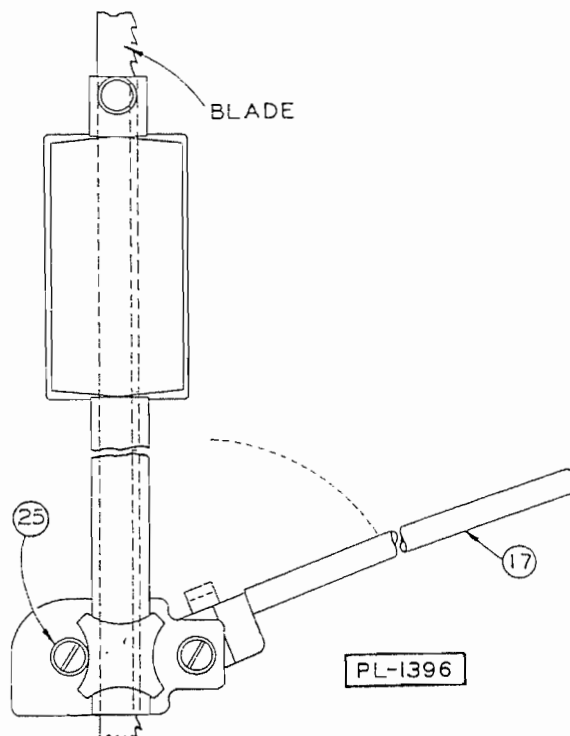
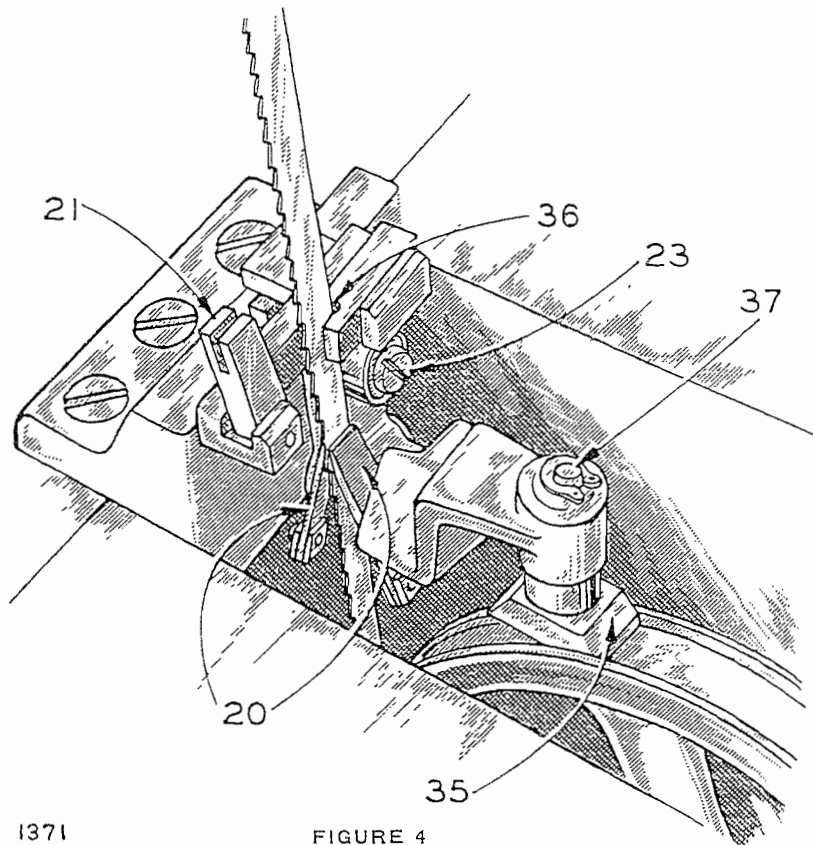

FIGURE 3
UPPER GUIDE ASSEMBLY



1371

FIGURE 4
LOWER SCRAPER UNIT

To slice short ends, use the pusher plate 30 (fig. 5) to hold the meat against the gage plate. A groove in the pusher slips over and slides along the up-turned edge of the carriage. Hold the pusher with your right hand as shown in fig. 5. Your hand will then always be a safe distance from the saw blade and the stop 31 will prevent the pusher from going too far. When not using the pusher plate, keep it on the inside of door 11 where provision has been made for holding it. See illustration at the right in fig. 5.

VII - CLEANING

It is very important that any appliance used in the preparation of food be kept in a clean and sanitary condition and this machine has been designed to make cleaning a quick and easy job. In moderate weather, cleaning every evening at the close of business should be sufficient, but, in hot sultry climates, more frequent attention may be required.

Observe the following procedure:

(1) Open the head door 15 (fig. 1) and clean out inside. Ordinarily this can be done

without taking off the blade pulley, but the pulley can be removed and should be taken off occasionally and washed. Always see that the bore of the pulley is dry before replacing and rub a little oil in it. Be sure that the latch 22, (fig. 1) which retains the pulley, is down properly in the groove on the shaft.

Observe these same precautions in regard to the lower blade pulley.

(2) Take off the carriage, the table, and the lower guide assembly for cleaning. See paragraph VIII. Both the upper and lower guide assembly should be cleaned carefully.

(3) Take off the saw blade. See paragraph VIII.

(4) Pull out the drawer 19 and clean out the bone dust and meat particles thrown off the saw blade.

(5) Wipe over the entire surface of the machine with a damp cloth moistened with tasteless oil.

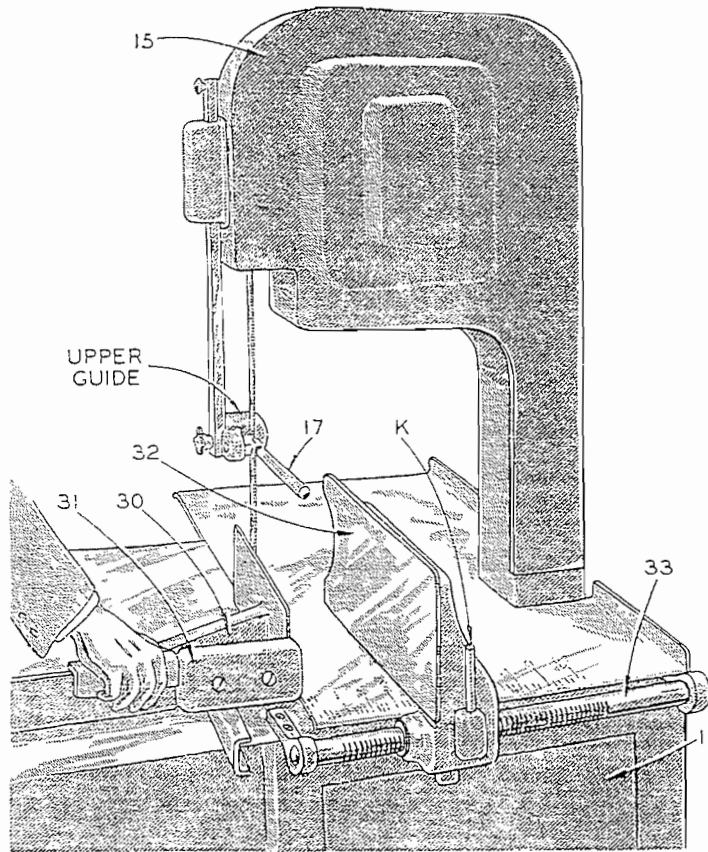
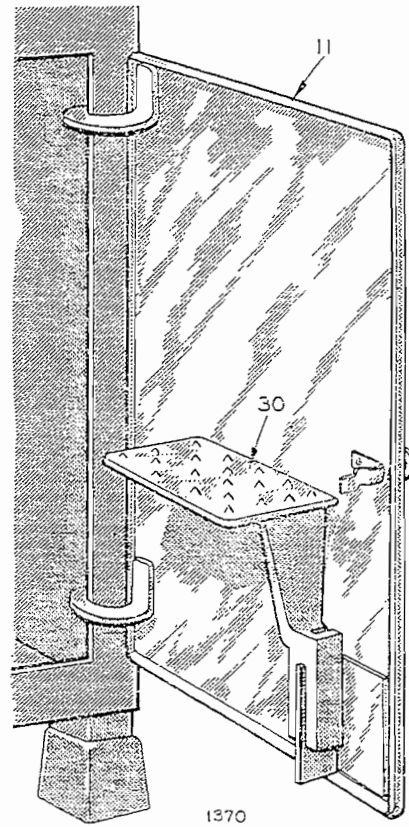

FIGURE 5



1370

VIII - CHANGING SAW BLADES

- (1) Take off the carriage. To release it, the plunger 18 (fig. 1) must be pushed down.
- (2) Unhook lock 13 and take off the table.
- (3) Open the head door 15 (fig. 1).
- (4) Swing down the guard 17 (fig. 3) to the horizontal position, swing up the bakelite guard 21 (fig. 4), and lift out the lower wiper unit.
- (5) Turn the Hand Wheel 12 (fig. 1) to the left to loosen the tension and lift off the saw blade.
- (6) Put on the new blade, turn the hand wheel to the right until the indicator reads "2", turn the upper blade pulley 27 by hand to center the blade, and then turn the hand wheel until the indicator registers between "3" and "4". Now move the guard 17 to the vertical position and insert the lower wiper unit.

IX - ADJUSTMENT OF THRUST ROLLERS

At the back edge of the saw blade in the upper guide and the lower wiper unit are ball bearing rollers which will take the cutting thrust. When the saw is running without load, the rollers should not touch the blade; the clearance being $1/32$ to $1/16$ inches. Always check this after putting in a new blade. Rollers may be adjusted to suit any variation in blade widths. Adjust the upper roller by turning the screw 25, (fig. 3) and the lower roller by turning screw 23, (fig. 4).

X - BLADE REPLACEMENT

Two saw blades are furnished as regular equipment with every machine. Replacement blades are available thru all Hobart offices.

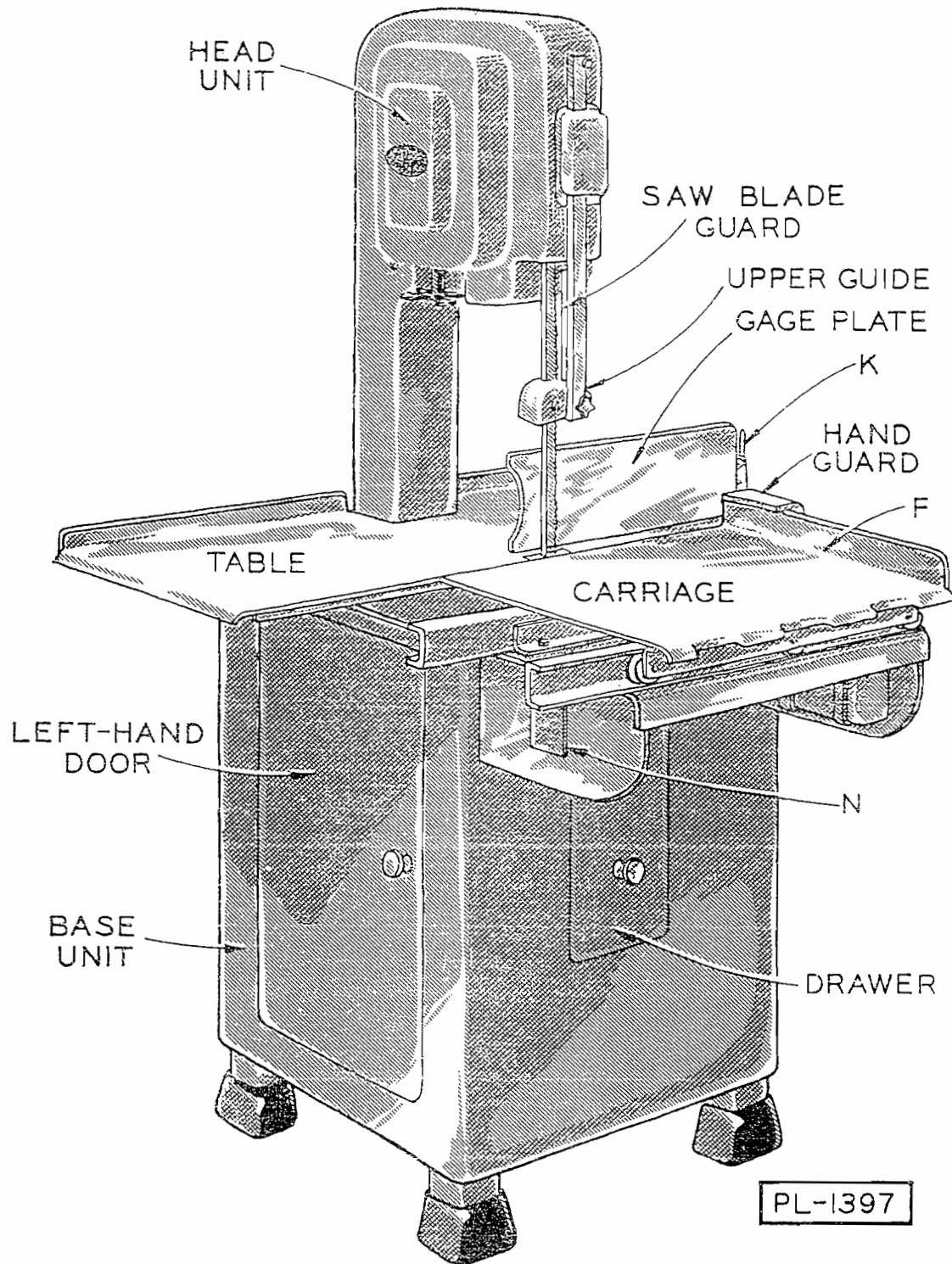
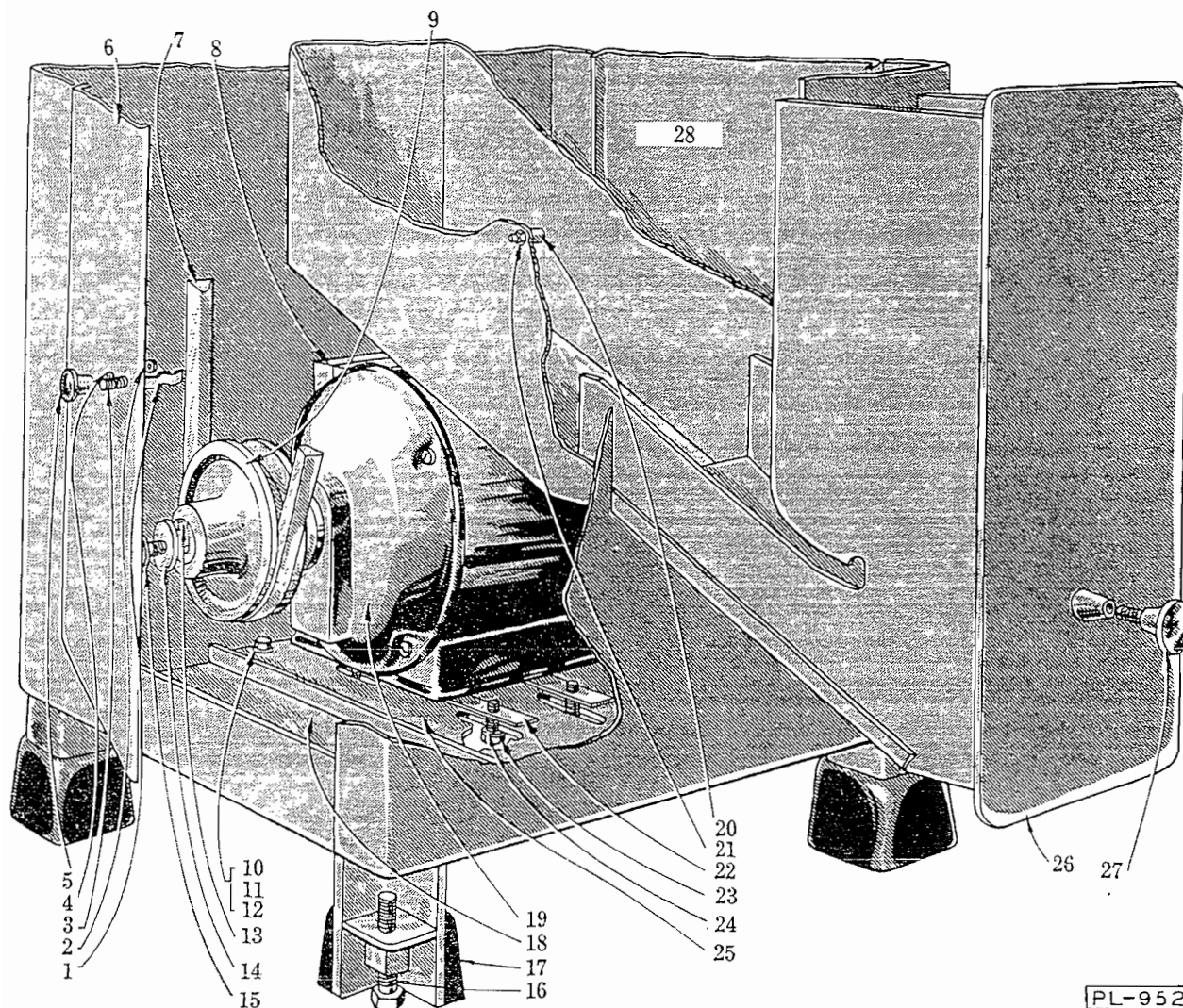

FIGURE 6

HOBART REPLACEMENT PARTS



BASE AND MAIN FRAME UNIT

ILLUS. PL-952	PART NUMBER	NAME OF PART	AMOUNT
1	V-20894	Clip - Spring	2
2	NS-9-21	Nut - #10-24 Hex.	2
3	SC-7-77	Mach. Screw - #10-24 x 1 1/2" Rd. Hd.	2
4	SC-7-71	Mach. Screw - #10-24 x 1 1/4" Rd. Hd.	2
5	M-23274	Knob - Base Door	2
6	S-23332	Door - L.H. Base	1
7	BV-5-4	V-Belt	1
8	P-23212	Box - Junction	1
9	P-20819	Pulley - Motor	1
10	SC-36-27	Cap Screw - 5/16"-18 x 1" Hex Hd.	4
11	NS-31-28	Lock Nut - 5/16"-18 "Elastic"	4
12	WS-4-25	Washer	8
13	R-12430-62	Key	1
14	WS-3-30	Washer	1
15	V-3404-2	Screw	1
16	V-20991	Bolt - Leveling	4
17	M-20899	Foot	4
18	P-23230	Cover - Bottom Frame	1
19		Motor (Give Elec. Spec.)	1
20	V-20877	Stud - Drawer Retaining	1
21	NS-17-7	Jam Nut - 5/16"-18 Hex.	1
22	M-23231	Booster - Motor	As reqd.
23	SC-36-83	Cap Screw - 7/16"-14 x 1" Hex Hd.	4
24	WS-7-11	Washer	4
25	P-23229	Base - Motor	1
26	S-23353	Drawer Assembly	1
27	M-20838-3	Knob - Drawer	1
28	S-23331	Door - R.H. Base	1
	SC-9-92	Mach. Screw - #10-32 x 2" Rd. Hd. (Retains Item #8)	4

HOBART REPLACEMENT PARTS

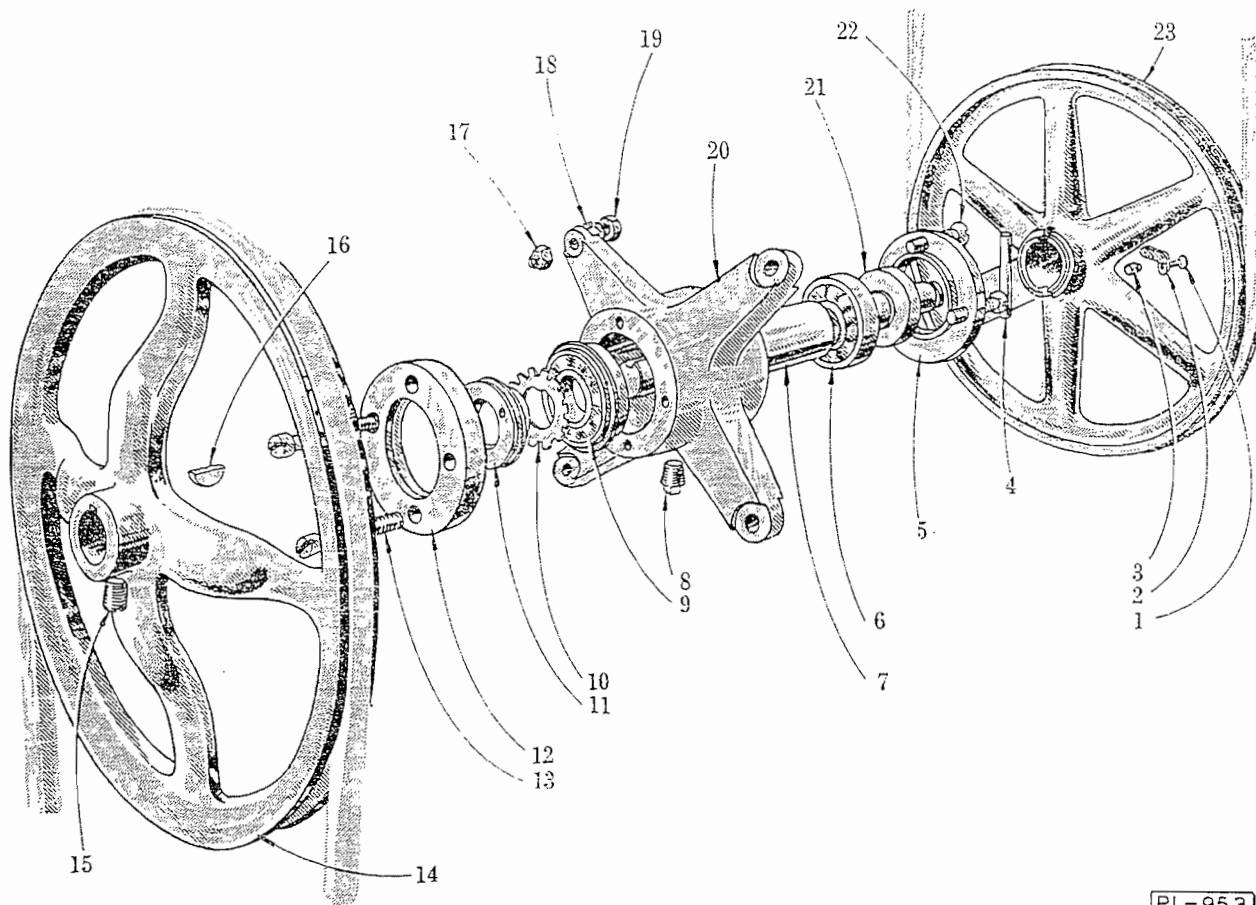

PL-953

LOWER BEARING CARRIER UNIT

ILLUS.	PART	NAME OF PART	AMOUNT
PL-953	NUMBER		
1	V-20851	Screw - Latch	1
2	M-20852	Latch	1
3	M-24114	Catch - #3 1/4 Frost	1
4	PG-7-23	Groov-Pin - Type 5, 5/16" x 1-3/4"	1
5	M-23329	Retainer - Seal	1
6	BB-6-41	Ball Bearing - ND #7507	1
7	R-20839	Shaft - Lower Brg. Carrier Drive	1
8	FP-28-5	Plug - 1/4" Pipe	1
9	BB-6-43	Ball Brg. - N.D. #43207	1
10	WL-12-8	Lock Washer N.D. W-07	1
11	M-20853	Nut - Lock	1
12	M-20786-1	Retainer - Bearing	1
13	SC-38-5	Cap Screw - 1/4"-20 x 1" FH. Hd.	4
14	S-20818	Pulley - Drive	1
15	SC-47-43	Set Screw - 3/8"-16 x 1/2" Soc. Hdls. Kn. Cup Pt.	1
16	KW-3-10	Woodruff Key - #606	1
17	NS-31-37	Lock Nut - 1/2"-13 "Elastic"	4
18	WL-4-12	Lock Washer - 1/2" x .170" x .099"	4
19	NS-17-27	Jam Nut - 1/2"-13 Hex	4
20	R-23232	Carrier - Lower Bearing	1
21	M-23637	Seal - Grease	1
22	SC-13-85	Mach. Screw - 1/4"-20 x 3/4" Flat Hd.	4
23	M-60294	Flanged Blade Pulley Sub-Assy. Unit (Includes items #1, 2 & 3)	1
	R-23367	Lower Brg. Carrier Sub-Assy. (Includes items #4, 5, 6, 7, 8, 9, 10, 11, 12, 13, 20, 21 & 22)	1

HOBART REPLACEMENT PARTS

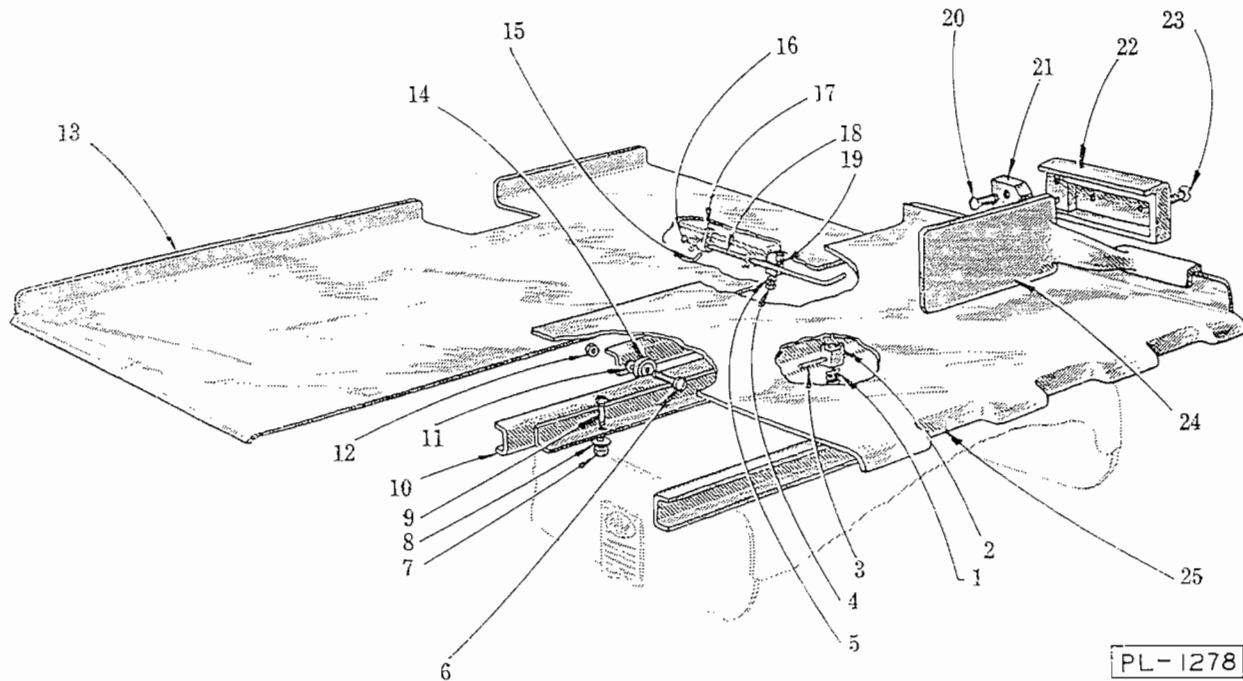

TABLE, TRACK AND CARRIAGE UNIT

ILLUS. PL-1278	PART NUMBER	NAME OF PART	AMOUNT
1	V-23227	Spring - Carriage Stop	1
2	M-23248	Stop - Carriage	1
3	PG-7-18	Groov-Pin - Type 5, 1/4" x 1"	1
4	SC-36-2	Cap Screw - 1/4"-20 x 1/2" Hex Hd.	4
5	WL-3-26	Lock Washer - 1/4" x .107" x .047"	4
6	V-20866	Screw - Roller Retaining	6
7	NS-31-28	Lock Nut - 5/16"-18 "Elastic"	4
8	WS-4-25	Washer	4
9	SC-8-88	Mach. Screw - 5/16"-18 x 3/4" Rd. Hd.	4
10	R-23272	Track Assembly	2
11	WS-4-19	Washer	6
12	NS-31-28	Lock Nut - 5/16"-18 "Elastic"	6
13	S-23250	Table Assembly	1
14	BB-8-2	Ball Bearing - Nice #400-24	6
15	PG-7-9	Groov-Pin - Type 5, 1/8" x 5/8"	1
16	RR-4-2	Retaining Ring	1
17	M-23254	Cam - Table Locking	1
18	P-23253	Lever - Table Locking	1
19	V-24121	Table Rest Assembly	4
20	SC-13-54	Mach. Screw - #10-24 x 7/8" Flat Hd.	2
21	V-20893	Guard - Saw Blade	1
22	P-20816-2	Guard - Hand	1
23	SC-15-84	Mach. Screw - 1/4"-20 x 7/8" Oval Ctsk. Hd.	2
24	S-20967	Plate - Butt End Push	1
25	R-20859	Carriage Assembly	1

HOBART REPLACEMENT PARTS

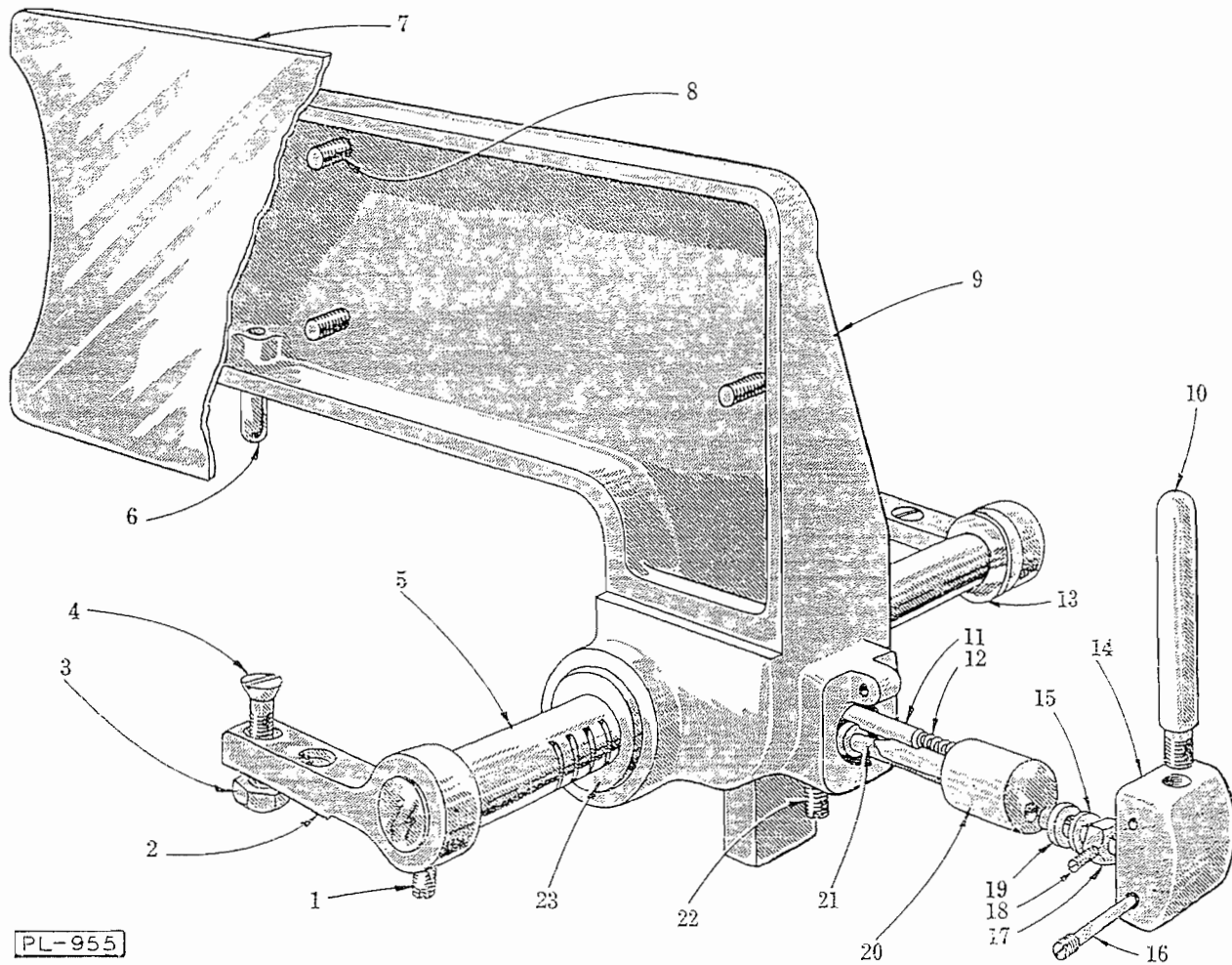

PL-955

GAGE PLATE UNIT

ILLUS. PL-955	PART NUMBER	NAME OF PART	AMOUNT
1	SC-47-15	Set Screw - 1/4"-20 x 1/2" Soc. Hdls. Kn. Cup Pt.	2
2	P-23233	Bracket - Rack Support	2
3	NS-31-17	Lock Nut - 1/4"-20 "Elastic"	4
4	SC-13-91	Mach. Screw - 1/4"-20 x 1-1/4" Flat Hd.	4
5	P-23361	Rack - Gage Plate	1
6	V-20863	Shoe - Gage Plate	1
7	R-23356	Gage Plate Sub-Assy.	1
8	SC-15-85	Mach. Screw - 1/4"-20 x 3/4" Oval Ctsk. Hd.	3
9	P-63284	Support - Gage Plate (Includes item #23)	1
10	M-23345	Handle	1
11	M-23360	Plunger	2
12	V-7009	Spring - Plunger	2
13	V-23736	Washer - Bumper	1
14	P-23321	Cap - Trip Lever	1
15	WL-7-15	Lock Washer - 1/4" Ext. Shakeproof	1
16	V-20895	Pin - Special	1
17	NS-17-1	Jam Nut - 1/4"-20 Hex	1
18	V-23347	Screw - Hinge	2
19	M-23346	Nut - Gage Plate	1
20	M-23348	Cartridge	1
21	M-23357	Screw - Special	1
22	SC-47-43	Set Screw - 3/8"-16 x 1/2" Soc. Hdls. Kn. Cup Pt.	1
23	V-20826	Bushing - Gage Plate	2
	S-23341	Gage Plate Assy. (Includes items #5, 6, 7, 8, 9, 10, 11, 12, 14, 15, 16, 17, 18, 19, 20, 21, 22 & 23)	1

This technical drawing is an exploded view of a mechanical assembly, likely a door latch or lock mechanism. It shows the relationship between various components, which are numbered for identification. The components include:

- 1-3:** A small bracket or pin assembly at the bottom center.
- 4-9:** A series of plates or guides on the right side.
- 10-14:** A vertical assembly at the bottom, possibly a handle or lever.
- 15-26:** Various internal components, including springs, pins, and structural parts.
- 27-39:** A complex assembly on the left, including a large cylindrical component (39) and a rectangular plate (40).
- 40-43:** A rectangular plate or cover on the far left.
- 44-49:** Various structural and mounting components.
- 50-58:** A central assembly featuring a large circular component (51) and various connecting parts.
- 59-62:** A large, complex housing or frame on the right.
- 63-68:** Additional components on the right side, including a handle or lever (63).
- 69:** A long vertical rod or pin at the bottom right.

The diagram uses perspective to show the spatial arrangement of these parts, with lines indicating how they fit together.

ILLUS. PART PL-1726 NO.			NAME OF PART		AMOUNT	ILLUS. PART PL-1726 NO.			NAME OF PART		AMOUNT
1	SC-13-46	Mach. Screw - #10-24 x 1/2"				38	SC-38-2	Cap Screw - 1/4"-20 x 3/4"			
		Flat Hd.			6			Flt. Hd.			4
2	NS-21-11	Stop Nut - #10-24 "Elastic"			12	39	P-20794-1	Cap - L.H. Upper Bearing			1
3	WS-2-19	Washer			12	40	S-23267	Cover - Head			1
4	PG-7-18	Groov-Pin - Type 5, 1/4" x 1"			1	41	V-20846	Retainer - Upper Bearing			1
5	M-23262	Nut - Blade Tension Adj.			1	42	SC-13-46	Mach. Screw - #10-24 x 1/2"			2
6	M-23264	Screw - Blade Tension Adj.			1			Flat Hd.			
7	BB-13-1	Ball Bearing - Nice #603			1	43	SC-36-56	Finish. Bolt - 3/8"-16 x 1-1/8"			1
8	M-23265	Spool - Adj. Blade Tension			1			Hex. Hd.			1
9	M-20867	Spring - Adj. Blade Tension			1	44	NS-17-14	Jam Nut - 3/8"-16 Hex Finish.			1
10	M-23271	Hinge - Door to Head			2	45	WL-4-2	Lock Washer - 3/8" x .136" x .070"			1
11	SC-13-54	Mach. Screw - #10-24 x 7/8"			6	46	BB-6-43	Ball Bearing - N.D. #43207			1
		Flat Hd.			1	47	R-23263	Slide - Upper Bearing Carrier			1
12	WC-4-16	Ctsk. Washer - 1/4"			1	48	V-20854	Pin - Hinge			1
13	SC-16-2	Mach. Screw - 1/4"-20 x 1" Oval			1	49	BB-7-41	Ball Bearing - N.D. #99507			1
		Ctsk. Hd.			1	50	M-20849	Gib			2
14	SC-40-37	Cap Screw - 1/2"-13 x 2" Soc.			4	51	P-11800-206	Dowel (Cover to Head)			2
		Flt. Hd.			1	52	SC-14-43	Mach. Screw - 1/4"-20 x 2-1/2"			2
15	NS-31-37	Stop Nut - 1/2"-13 "Elastic"			1	53	PG-7-23	Groov-Pin - Type 5, 5/16" x 1-3/4"			1
16	WS-3-35	Washer			1	54	SC-13-79	Mach. Screw - 1/4"-20 x 1/2"			4
17	P-23266	Wheel - Hand			1			Flat Hd.			
18	SC-40-24	Cap Screw - 3/8"-16 x 1-1/2"			2			Flat Hd.			
		Soc. Flt. Hd.			1	55	M-20793	Cap - R.H. Upper Bearing			1
19	RR-4-8	Retaining Ring			1	56	M-24114	Catch - #8-1/2 Frost			1
20	SC-14-26	Mach. Screw - 3/8"-16 x 1-1/2"			1	57	M-20852	Latch			1
		Flat Hd.			1	58	V-20851	Screw - Latch			1
21	R-64323	Shield - Head			1	59	S-23270	Door - Head			1
22	SD-7-15	Self-Tapping Screw - #6 x 3/16"			3	60	NS-21-11	Stop Nut - #10-24 "Elastic"			2
		Phillips Bind. Hd., Type B			8	61	SC-13-43	Mach. Screw - #10-24 x 3/8"			2
23	SC-40-14	Cap Screw - 5/16"-18 x 3/4" Soc.			1			Flat Hd.			
		Flt. Hd.			1	62	V-20894	Clip - Spring			1
24	P-20856	Shaft - Upper			1	63	M-63642	Screw - Spring Clip			1
25	M-23257	Dial - Indicator			2	64	T-23256	Head			1
26	SC-19-14	Mach. Screw - #10-24 x 1/4"			1	65	M-60294	Flanged Pulley (Blade) Sub-Assy.			
		Bind. Hd.			1			Unit (Includes items #56, 57 & 58)			1
27	V-23259	Pointer - Indicator			1	66	M-23235	Ring - Lens Retaining			1
28	V-23258	Arm - Lever for Indicator			1	67	V-20889	Lens - Indicator			1
29	V-23261	Screw - Special for Lever			1	68	V-20896	Gasket - Indicator Lens			1
30											

HOBART REPLACEMENT PARTS

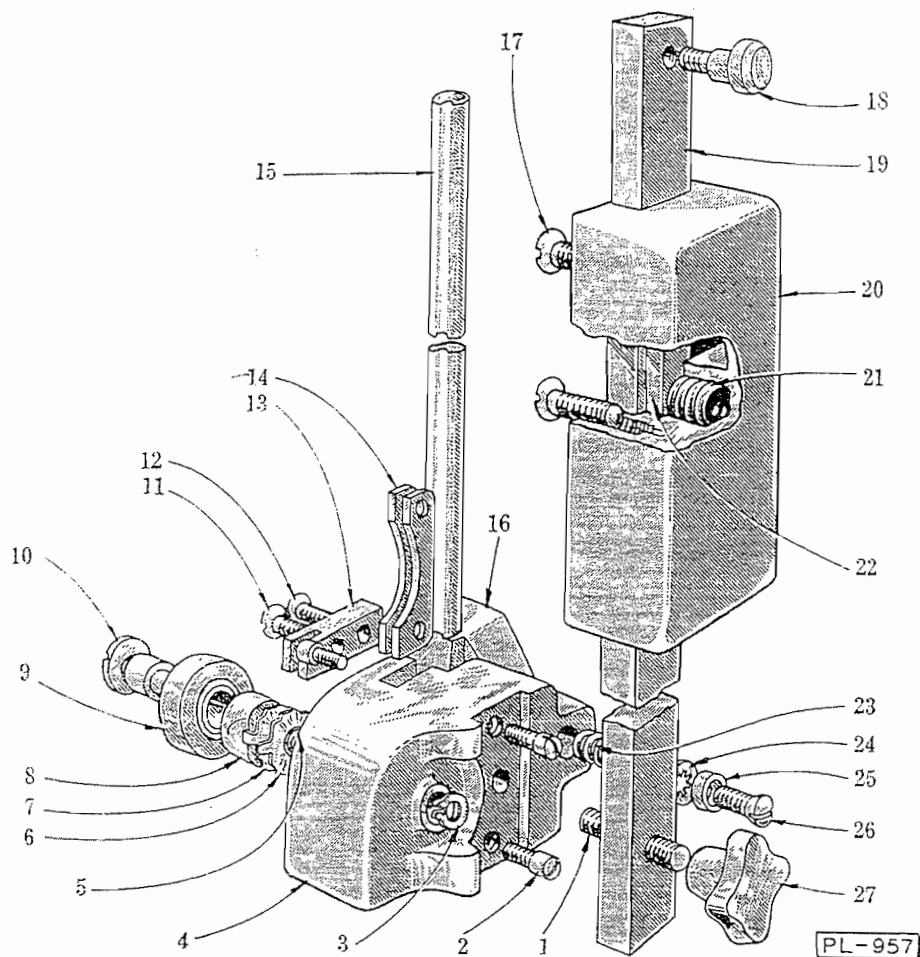

UPPER GUARD UNIT

ILLUS.	PART	NAME OF PART	AMOUNT
PL-957	NUMBER		
1	V-21158	Stud	1
2	SC-11-51	Mach. Screw - #10-32 x 5/16" Fil. Hd.	1
3	RR-4-4	Retaining Ring	1
4	P-23273	Support - Upper Guide	1
5	V-23326	Spring	1
6	M-23275	Washer (Stationary)	1
7	M-23328	Washer (Rotating)	1
8	M-23236	Shaft	1
9	BB-5-11	Ball Bearing - Fafnir #201 PP	1
10	V-20840	Screw - Bearing Retaining	1
11	SC-15-49	Mach. Screw - #10-24 x 5/8" Oval Ctsk. Hd.	1
12	SC-15-49	Mach. Screw - #10-24 x 5/8" Oval Ctsk. Hd.	1
13	V-20845	Guard - Upper	1
14	V-20802	Guide - Upper Blade	2
15	V-20901	Guard - Saw Blade	1
16	M-20798	Support - Guard	1
17	SC-10-30	Mach. Screw - 1/4"-20 x 1" Truss Hd.	5
18	V-20891	Stop - Slide Bar	1
19	M-20848	Bar - Slide	1
20	P-20797-3	Guide - Slide Bar	1
21	M-18046	Spring - Shoe	1
22	V-20855	Shoe - Slide Bar	1
23	V-20963	Spring - Blade Guard	1
24	WL-8-15	Lock Washer - 1/4" Internal Shakeproof	1
25	V-20850	Washer - Retaining	1
26	SC-15-61	Mach. Screw - 1/4"-20 x 1/2" Oval Ctsk. Hd.	1
27	M-21159	Knob - Upper Guide Support	1
	P-20954	Guard Support & Blade Guard Sub-Assy. (Includes items #11, 12, 13, 15 & 16)	1
	S-23365	Upper Guard Sub-Assy. (Includes items #1, 2, 3, 4, 5, 6, 7, 8, 9, 10, 11, 12, 13, 14, 15, 16, 18, 19, 23, 24, 25, 26 & 27)	1

HOBERT REPLACEMENT PARTS

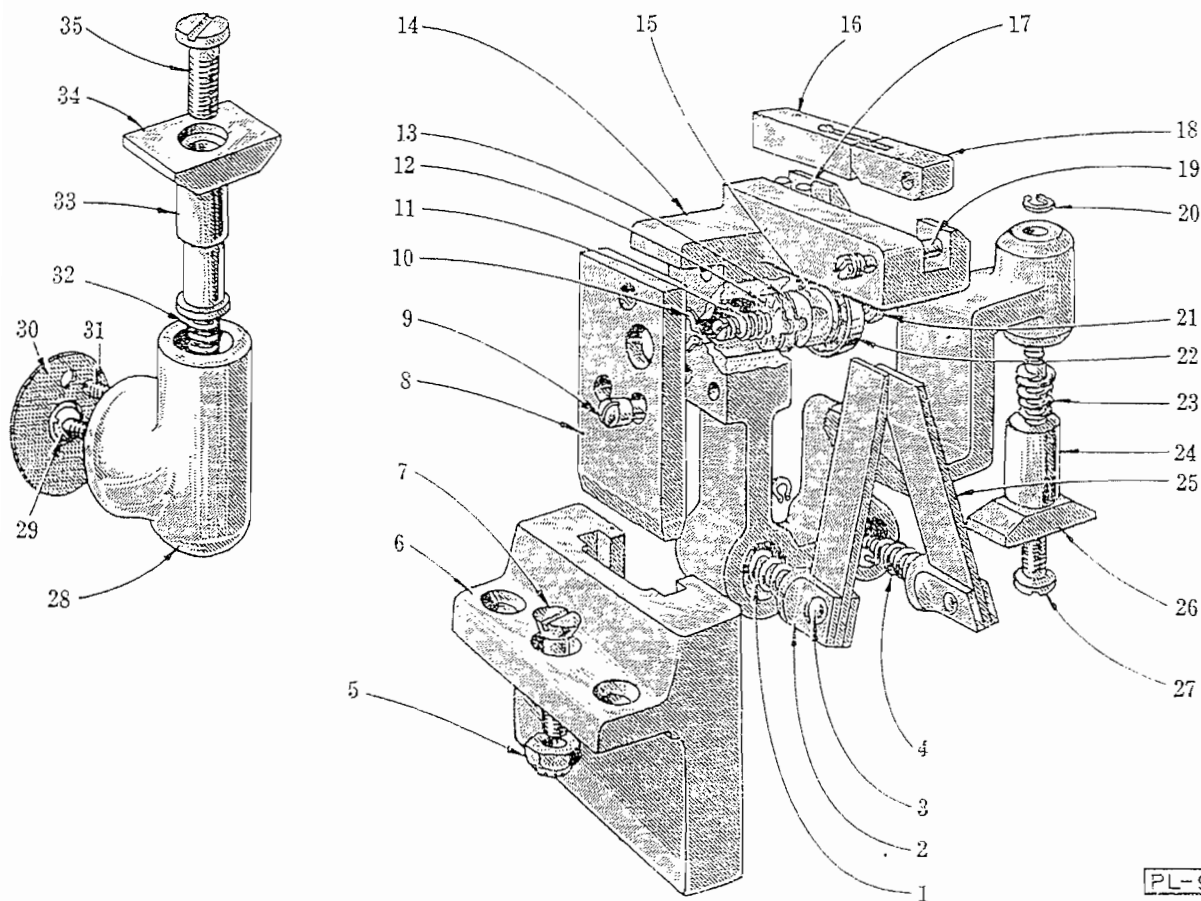

PL-958

UPPER AND LOWER WIPER AND GUIDE UNIT

ILLUS.	PART	NAME OF PART	AMOUNT
PL-958	NUMBER		
1	M-20931	Spring - R.H. Tension	1
2	M-20831	Holder - Blade Wiper	2
3	SC-15-48	Mach. Screw - #10-24 x 7/16" Oval Ctsk. Hd.	2
4	M-20932	Spring - L.H. Tension	1
5	NS-31-17	Stop Nut - 1/4"-20 "Elastic"	1
6	P-23233	Slideway - Wiper Bracket	1
7	SC-13-88	Mach. Screw - 1/4"-20 x 1" Flat Hd.	1
8	M-23234	Slide - Lower Wiper Brkt.	1
9	SC-35-1	Cap Screw - 1/4"-20 x 1 1/2" Flt. Hd.	2
10	RR-4-4	Retaining Ring	1
11	V-23326	Spring	1
12	M-23275	Washer	1
13	M-23328	Washer	1
14	R-23235	Bracket - Wiper	1
15	M-23236	Shaft	1
16	M-20836	Guide - Lower Saw Blade	1
17	SC-11-48	Mach. Screw - #10-24 x 5/8" Flt. Hd.	2
18	V-20865	Guard - Lower Saw Blade	1
19	V-20895	Pin - Hinge	1
20	RR-4-2	Retaining Ring	2
21	V-20840	Screw - Bearing Retaining	1
22	BB-5-11	Ball Bearing - Fafnir #201-PP	1
23	V-7433-2	Spring	1
24	V-20837	Plunger	1
25	M-20829	Wiper - Saw Blade	2
26	M-22027	Wiper - Blade Pulley	1
27	V-3404-6	Screw	1
28	P-23268	Bracket - Upper Wiper	1
29	SC-14-26	Mach. Screw - 3/8"-16 x 1-1/2" Flat Hd.	1
30	M-24567	Gasket - Wiper Bracket	As reqd.
31	SC-46-13	Set Screw - #10-24 x 1/2" Slot. Hdls. Flat Pt.	2
32	M-23225	Spring - Upper Wiper	1
33	M-23269	Plunger - Upper Wiper	1
34	M-22027	Wiper	1
35	V-3404-6	Screw	1
	SC-46-17	Set Screw - #10-24 x 3/8" Slot. Hdls. Flat Pt. (Used with item #14)	1
	S-23366	Lower Wiper Sub-Assy. (Includes items #1, 2, 3, 4, 8, 9, 10, 11, 12, 13, 14, 15, 16, 17, 18, 19, 20, 21, 22, 23, 24, 25, 26 & 27)	1
	M-23349	Upper Blade Pulley Wiper Sub-Assy. (Includes items #28, 31, 32, 33, 34 & 35)	1

HOBART REPLACEMENT PARTS

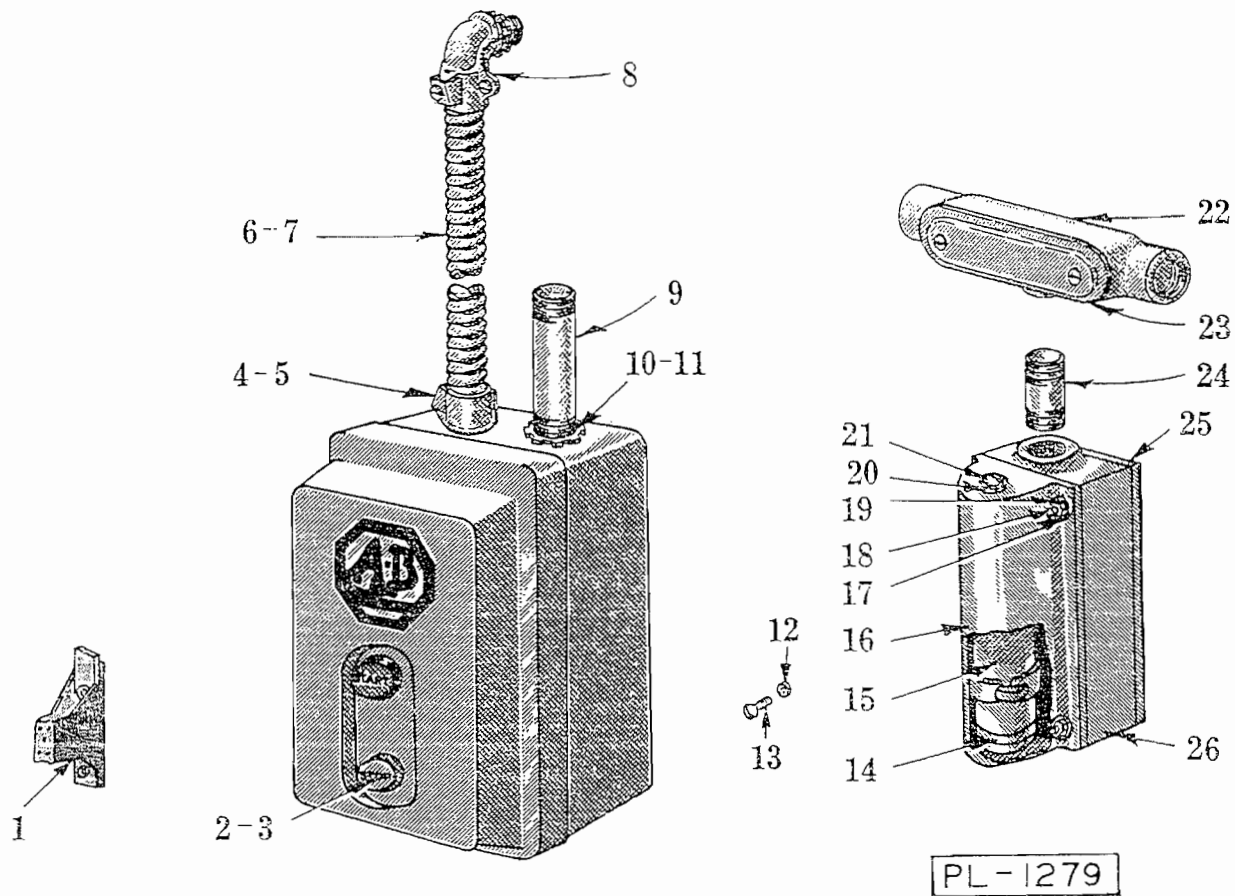

STARTER EQUIPMENT

ILLUS. PL-1279	PART NO.	NAME OF PART	AMOUNT
1	-----	Starter Element (Give Elec. Spec.)	1
2	-----	Starter - (A.C.) (Give Elec. Spec.)	1
*3	-----	Starter - (D.C.) (Give Elec. Spec.)	1
4	FE-2-13	Connector - 1/2" (For 1/2" Flex. Cond.)	1
5	WS-12-24	Washer	1
6	P-24127-11	Conduit - 1/2" x 27" Lg. Flexible	1
7	BF-2-17	Bushing - 1/2" Anti-Short	2
8	FE-2-31	Connector - 1/2 x 90° (For 1/2" Flex. Cond.)	1
9	FE-5-48	Conduit - 3/4" x 4" Lg. Rigid	1
10	FE-6-6	Lock Nut - 3/4" Conduit	1
11	FE-6-9	Bushing - 3/4" Conduit	1
12	NS-9-21	Nut - #10-24 Hex	4
13	SC-7-74	Mach. Screw - #10-24 x 3/8" Rd. Hd.	4
*14	WS-3-9	Washer	2
*15	P-20175	Coil - Resistance (Give Voltage)	1
*16	P-14670	Box - Resistance Coil	1
*17	WL-3-22	Lock Washer - #10 x .055" x .040"	4
*18	SC-7-91	Mach. Screw - #10-24 x 2-1/4" Rd. Hd.	4
*19	NS-9-21	Nut - #10-24 Hex	4
*20	WL-3-43	Lock Washer - 5/16" x .117" x .056"	2
*21	SC-8-88	Mach. Screw - 5/16"-18 x 3/4" Rd. Hd.	2
*22	FE-3-4	Junction Box - Resistor	1
*23	FE-4-13	Cover - Junction Box	1
*24	FE-5-3	Conduit - 1/2" x 1-1/2" Lg. Rigid	1
*25	P-20969	Cover - Connection Box	1
*26	R-20968	Box - Connection	1

* D.C. Starter Equipment