

# VULCAN

## CATALOG OF REPLACEMENT PARTS

### HGB SERIES CHARBROILERS

#### PRIOR MLS

|        |          |
|--------|----------|
| HGB34  | ML-27850 |
| HGB34M | ML-27885 |
| HGB50  | ML-27851 |
| HGB50M | ML-27886 |
| HGB60  | ML-27852 |
| HGB60M | ML-27887 |
| HGB71  | ML-27853 |
| HGB71M | ML-27888 |

#### CURRENT MODELS

|        |           |
|--------|-----------|
| HGB34  | ML-135520 |
| HGB34M | ML-135524 |
| HGB50  | ML-135521 |
| HGB50M | ML-135525 |
| HGB60  | ML-135522 |
| HGB71  | ML-135523 |



For additional information on Vulcan-Hart or to locate an authorized parts and service provider in your area, visit our website at [www.vulcanhart.com](http://www.vulcanhart.com)

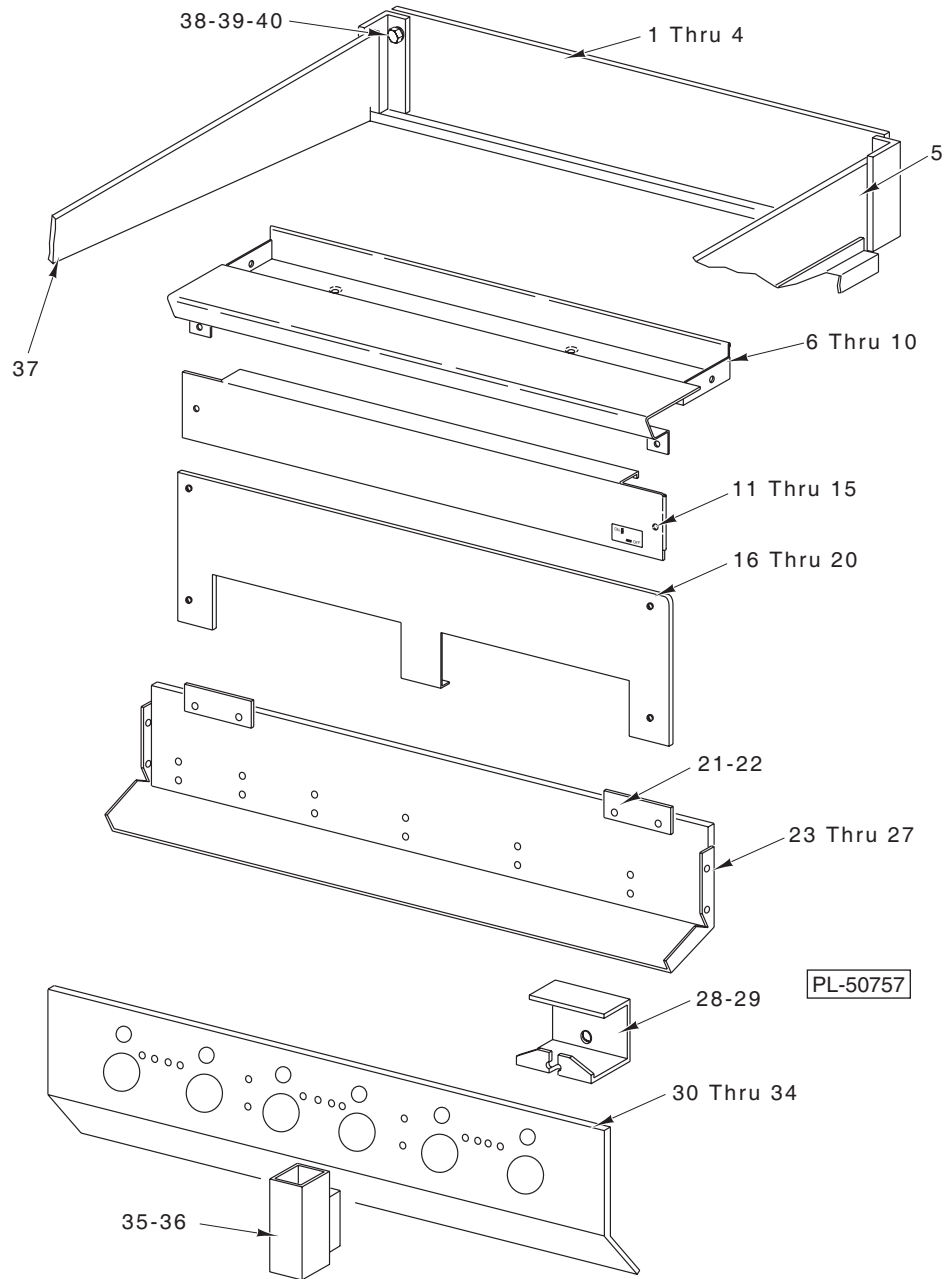

**PANEL**

## PANEL

| ILLUS.<br>PL-50757 | PART<br>NO.     | NAME OF PART  | AMT. |
|--------------------|-----------------|---|------|
| 1                  | 00-812013-00005 | Back - Back Splash (HGB 34) .....                     | 1    |
| 2                  | 00-812013-00001 | Back - Back Splash (HGB 50)(Optional) .....           | 1    |
| 3                  | 00-812013-00002 | Back - Back Splash (HGB 60)(Optional) .....           | 1    |
| 4                  | 00-812013-00003 | Back - Back Splash (HGB 71) .....                     | 1    |
| 5                  | 00-812019-00001 | Side Splash Assy.(R.H.) .....                         | 1    |
| 6                  | 00-811990-00010 | Front Top Assy. (HGB 34) .....                        | 1    |
| 7                  | 00-811990-00001 | Front Top Assy. (HGB 50) .....                        | 1    |
| 8                  | 00-811990-00002 | Front Top Assy. (HGB 60) .....                        | 1    |
| 9                  | 00-811990-00003 | Front Top Assy. (HGB 71) .....                        | 1    |
| 10                 | SD-022-48       | Self-Tapping Screw 10-16 x 1/2 Pan Hd., Type AB ..... | 2    |
| 11                 | 00-811993-00005 | Panel - Upper (HGB 34) .....                          | 1    |
| 12                 | 00-811993-00001 | Panel - Upper (HGB 50) .....                          | 1    |
| 13                 | 00-811993-00002 | Panel - Upper (HGB 60) .....                          | 1    |
| 14                 | 00-811993-00003 | Panel - Upper (HGB 71) .....                          | 1    |
| 15                 | SD-022-48       | Self-Tapping Screw 10-16 x 1/2 Pan Hd., Type AB ..... | 2    |
| 16                 | 00-811992-00005 | Panel - Lower (HGB 34) .....                          | 1    |
| 17                 | 00-811992-00001 | Panel - Lower (HGB 50) .....                          | 1    |
| 18                 | 00-811992-00002 | Panel - Lower (HGB 60) .....                          | 1    |
| 19                 | 00-811992-00003 | Panel - Lower (HGB 71) .....                          | 1    |
| 20                 | SD-022-48       | Self-Tapping Screw 10-16 x 1/2 Pan Hd., Type AB ..... | 4    |
| 21                 | 00-812023       | Plate - Grate Stop .....                              | 2    |
| 22                 | SD-022-48       | Self-Tapping Screw 10-16 x 1/2 Pan Hd., Type AB ..... | 4    |
| 23                 | 00-811984-00010 | Burner Box Back Assy. (HGB 34) .....                  | 1    |
| 24                 | 00-811984-00001 | Burner Box Back Assy. (HGB 50) .....                  | 1    |
| 25                 | 00-811984-00002 | Burner Box Back Assy. (HGB 60) .....                  | 1    |
| 26                 | 00-811984-00003 | Burner Box Back Assy. (HGB 71) .....                  | 1    |
| 27                 | SD-022-48       | Self-Tapping Screw 10-16 x 1/2 Pan Hd., Type AB ..... | 4    |
| 28                 | 00-811687       | Support - Burner .....                                | 6    |
| 29                 | SC-018-11       | Mach. Screw 10-24 x 3/8 Pan Hd. ....                  | 12   |
| 30                 | 00-811985-00005 | Front - Burner Box (HGB 34) .....                     | 1    |
| 31                 | 00-811985-00001 | Front - Burner Box (HGB 50) .....                     | 1    |
| 32                 | 00-811985-00002 | Front - Burner Box (HGB 60) .....                     | 1    |
| 33                 | 00-811985-00003 | Front - Burner Box (HGB 71) .....                     | 1    |
| 34                 | SD-022-48       | Self-Tapping Screw 10-16 x 1/2 Pan Hd., Type AB ..... | 4    |
| 35                 | 00-811988-00001 | Grease Tube Assy. ....                                | 2    |
| 36                 | SC-018-11       | Mach. Screw 10-24 x 3/8 Pan Hd. ....                  | 4    |
| 37                 | 00-812019-00002 | Side Splash Assy.(L.H.) .....                         | 1    |
| 38                 | SD-037-70       | Shoulder Bolt 1/4-20 .....                            | 2    |
| 39                 | WL-003-39       | Lockwasher 1/4 Light .....                            | 2    |
| 40                 | NS-013-02       | Full Nut 1/4-20 Hex .....                             | 2    |

\*Note: Quantities listed are for model HGB 34, unless otherwise noted.  
Quantities for other models may vary.

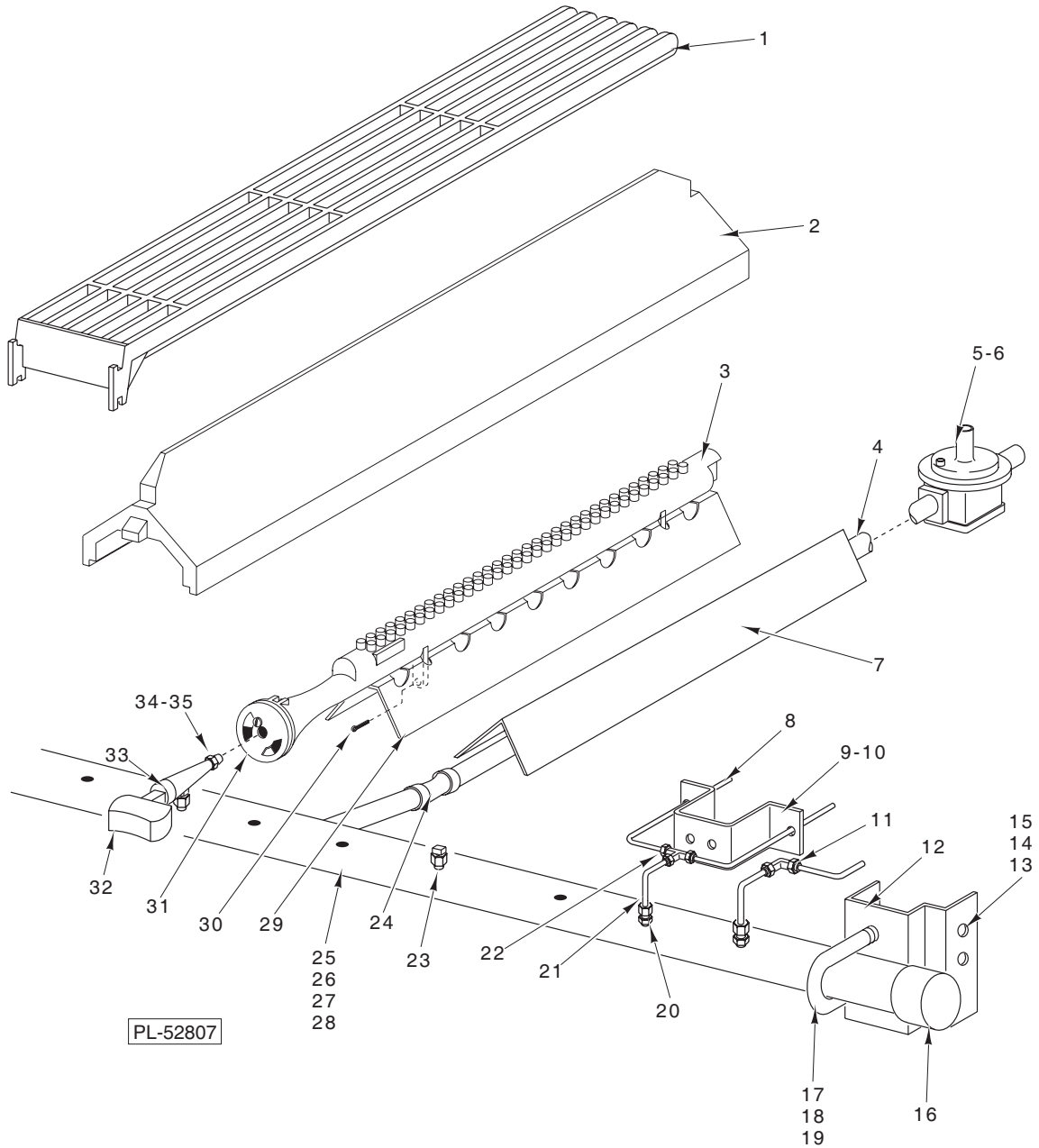

**GAS COMPONENTS**

## GAS COMPONENTS

| ILLUS.<br>PL-52807 | PART<br>NO.     | NAME OF PART  | AMT. |
|--------------------|-----------------|---|------|
| 1                  | 00-412852-00001 | Grate - Top .....   | 6    |
| 2                  | 00-410602-00001 | Radiant - Burner .....  | 6    |
| 3                  | 00-410600-000G2 | Burner (Incls. item 31) .....   | 6    |
| 4                  | 00-159757-00048 | Pipe - Feed (1 <sup>1</sup> / <sub>4</sub> x 27 <sup>1</sup> / <sub>2</sub> ) .....                     | 1    |
| 5                  | 00-408279-00012 | Regulator - Pressure (6.0 Outlet Pressure) (Natural) .....  | 1    |
| 6                  | 00-408279-00013 | Regulator - Pressure (10.0 Outlet Pressure) (Propane) .....   | 1    |
| 7                  | 00-812016       | Cover - Center Guide .....  | 1    |
| 8                  | 00-410607-000G1 | Tube - Pilot (with tip) .....   | 6    |
| 9                  | 00-812021       | Support - Pilot .....   | 3    |
| 10                 | SD-022-48       | Self-Tapping Screw 10-16 x 1 <sup>1</sup> / <sub>2</sub> Pan Hd., Type AB .....                         | 6    |
| 11                 | FP-047-22       | Elbow - Compression (HGB 50) .....  | 1    |
| 12                 | 00-812020       | Bracket - Manifold .....  | 2    |
| 13                 | SC-036-14       | Cap Screw 1 <sup>1</sup> / <sub>4</sub> -20 x 1 <sup>1</sup> / <sub>2</sub> Hex Hd. ....                | 4    |
| 14                 | WS-022-21       | Washer .....  | 4    |
| 15                 | WL-003-39       | Lockwasher 1 <sup>1</sup> / <sub>4</sub> Light .....  | 4    |
| 16                 | FP-029-23       | Cap - Pipe .....  | 2    |
| 17                 | 00-812043-00002 | Clamp - Manifold .....  | 2    |
| 18                 | NS-013-14       | Full Nut 5 <sup>1</sup> / <sub>16</sub> -18 Hex .....   | 4    |
| 19                 | WL-003-41       | Lockwasher 5 <sup>1</sup> / <sub>16</sub> Light .....   | 4    |
| 20                 | 00-404738-00003 | Valve - Pilot (Single) .....  | 3    |
| 21                 | 00-812022       | Tubing - Pilot .....  | 3    |
| 22                 | FP-081-74       | Tee 1 <sup>1</sup> / <sub>4</sub> x 1 <sup>1</sup> / <sub>4</sub> x 1 <sup>1</sup> / <sub>4</sub> ..... | 3    |
| 23                 | FP-028-45       | Plug - Pipe .....   | 1    |
| 24                 | FP-013-30       | Elbow 45 Deg. x 1 <sup>1</sup> / <sub>4</sub> .....   | 1    |
| 25                 | 00-812605-00005 | Manifold Pipe Assy. (HGB 34) .....  | 1    |
| 26                 | 00-812605-00004 | Manifold Pipe Assy. (HGB 50) .....  | 1    |
| 27                 | 00-812605-00003 | Manifold Pipe Assy. (HGB 60) .....  | 1    |
| 28                 | 00-812605-00002 | Manifold Pipe Assy. (HGB 71) .....  | 1    |
| 29                 | 00-410601-00001 | Plate - Burner Baffle .....   | 6    |
| 30                 | PC-003-56       | Cotter Pin 1 <sup>1</sup> / <sub>8</sub> x 1 .....  | 12   |
| 31                 | 00-404060-00001 | Shutter - Air .....   | 6    |
| 32                 | 00-413157-00001 | Handle - Valve .....  | 6    |
| 33                 | 00-812041-00001 | Valve - On/Off .....  | 6    |
| 34                 | 00-418051-00051 | Hood (Natural) .....  | 1    |
| 35                 | 00-418051-00057 | Hood (Propane) .....  | 1    |
|                    | 00-710412       | Brush W/Scraper .....   | 1    |

\*Note: Quantities listed are for model HGB34, unless otherwise noted.  
Quantities for other models may vary.

HGB SERIES CHARBROILERS REPLACEMENT PARTS

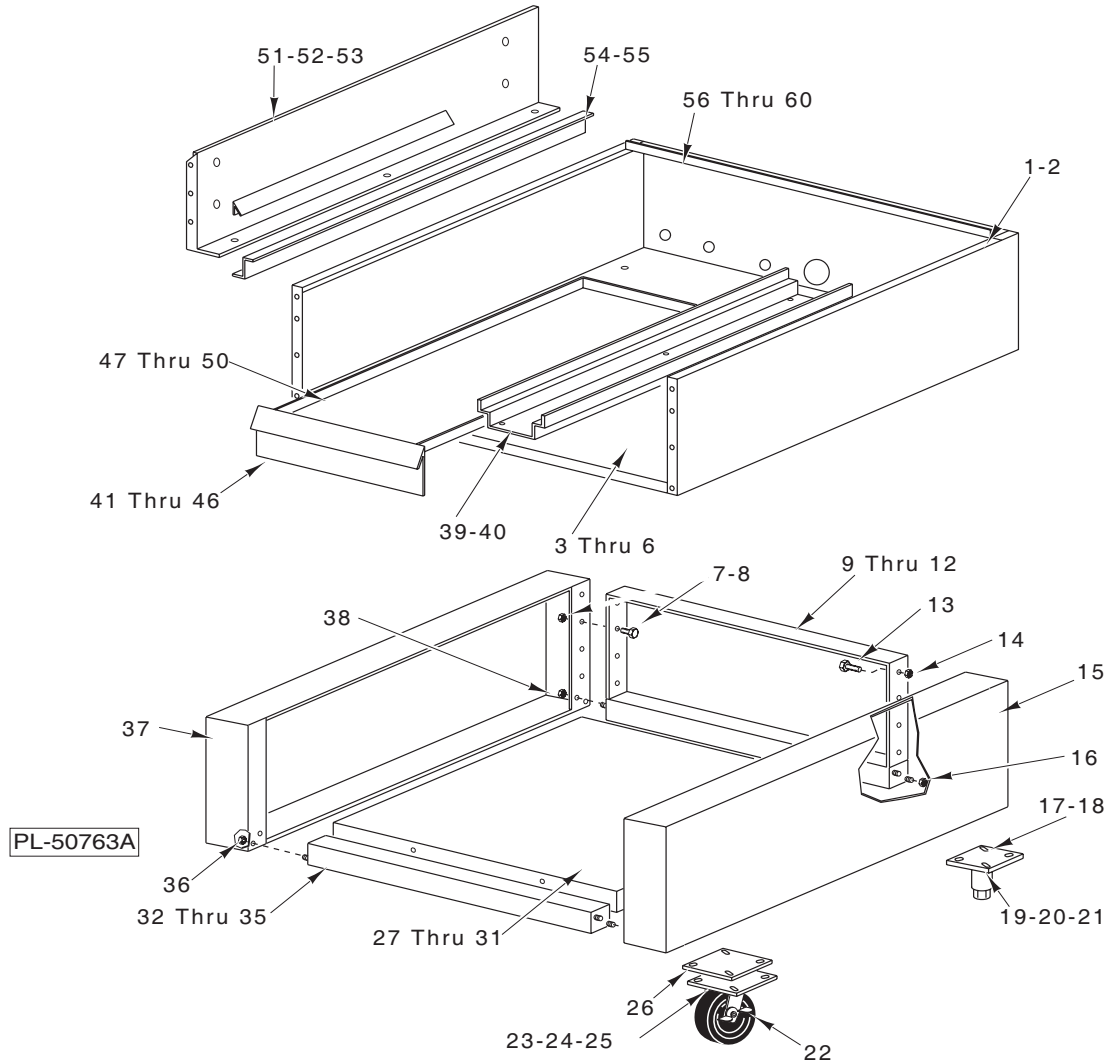

**BASE**

| ILLUS. | PART NO. | NAME OF PART  | AMT. |
|--------|----------|---|------|
|        | 1        | 00-811981-00002 Side-Main (Stainless Steel) .....               | 2    |
|        | 2        | SD-022-48 Self-Tapping Screw 10-16 x 1/2 Pan Hd., Type AB ..... | 2    |
|        | 3        | 00-811980-00005 Bottom - Body (HGB 34) .....                    | 1    |
|        | 4        | 00-811980-00001 Bottom - Body (HGB 50) .....                    | 1    |
|        | 5        | 00-811980-00002 Bottom - Body (HGB 60) .....                    | 1    |
|        | 6        | 00-811980-00003 Bottom - Body (HGB 71) .....                    | 1    |
|        | 7        | SC-041-05 Cap Screw 1/4-20 x 5/8 Hex Hd. ....                   | 4    |
|        | 8        | NS-031-19 Stop Nut 1/4-20 "Elastic" SST .....                   | 4    |
|        | 9        | 00-163715-00010 Back Assy. (SST)(HGB 34) .....                  | 1    |
|        | 10       | 00-163715-00005 Back Assy. (SST)(HGB 50) .....                  | 1    |
|        | 11       | 00-163715-00006 Back Assy. (SST)(HGB 60) .....                  | 1    |
|        | 12       | 00-163715-00007 Back Assy. (SST)(HGB 71) .....                  | 1    |
|        | 13       | SC-041-05 Cap Screw 1/4-20 x 5/8 Hex Hd. ....                   | 4    |
|        | 14       | NS-031-19 Stop Nut 1/4-20 "Elastic" SST .....                   | 4    |

## BASE (Cont.)

| ILLUS.<br>PL-50763A | PART<br>NO.     | NAME OF PART  | AMT. |
|---------------------|-----------------|---|------|
| 15                  | 00-811977-00002 | Side-Right (SST) .....  | 1    |
| 16                  | NS-032-35       | Stop Nut $\frac{5}{16}$ -18 "Flexloc" .....                     | 2    |
| 17                  | 00-413112-00001 | Adjustable Leg Assy. (Painted) (6") .....                       | 4    |
| 18                  | 00-413112-00012 | Ajustable Leg Assy. (SST) (6") .....                            | 4    |
| 19                  | SD-037-70       | Screw $\frac{1}{4}$ -20 x $\frac{1}{2}$ " .....                 | 16   |
| 20                  | WS-017-06       | Washer .....  | 16   |
| 21                  | NS-046-52       | Nut $\frac{1}{4}$ -20 Hex .....                                 | 16   |
| 22                  | 00-812080-00002 | Caster - Swivel & Brake (4 Dia) .....                           | AR   |
| 23                  | SD-037-70       | Screw $\frac{1}{4}$ -20 x $\frac{1}{2}$ " .....                 | 16   |
| 24                  | WS-017-06       | Washer .....  | 16   |
| 25                  | NS-046-52       | Nut $\frac{1}{4}$ -20 Hex .....                                 | 16   |
| 26                  | 00-812012       | Plate - Shim .....  | AR   |
| 27                  | 00-812641-00001 | Shelf - Cabinet (HGB 34) .....                                  | 1    |
| 28                  | 00-812641-00002 | Shelf - Cabinet (HGB 50) .....                                  | 1    |
| 29                  | 00-812641-00003 | Shelf - Cabinet (HGB 60) .....                                  | 1    |
| 30                  | 00-812641-00004 | Shelf - Cabinet (HGB 71) .....                                  | 1    |
| 31                  | SD-022-48       | Self-Tapping Screw 10-16 x $\frac{1}{2}$ Pan Hd., Type AB ..... | 8    |
| 32                  | 00-163714-00010 | Brace Assy. (HGB 34) .....                                      | 1    |
| 33                  | 00-163714-00005 | Brace Assy. (HGB 50) .....                                      | 1    |
| 34                  | 00-163714-00006 | Brace Assy. (HGB 60) .....                                      | 1    |
| 35                  | 00-163714-00007 | Brace Assy. (HGB 71) .....                                      | 1    |
| 36                  | NS-032-35       | Stop Nut $\frac{5}{16}$ -18 "Flexloc" .....                     | 4    |
| 37                  | 00-811977-00004 | Side-Left (SST) .....   | 1    |
| 38                  | NS-032-35       | Stop Nut $\frac{5}{16}$ -18 "Flexloc" .....                     | 2    |
| 39                  | 00-812015       | Guide - Center Tray .....                                       | 1    |
| 40                  | SD-022-48       | Self-Tapping Screw 10-16 x $\frac{1}{2}$ Pan Hd., Type AB ..... | 1    |
| 41                  | 00-811987-00005 | Handle - Grease Tray (HGB 34) .....                             | 2    |
| 42                  | 00-811987-00001 | Handle - Grease Tray (HGB 50) .....                             | 2    |
| 43                  | 00-811987-00002 | Handle - Grease Tray (HGB 60) .....                             | 2    |
| 44                  | 00-811987-00003 | Handle - Grease Tray (HGB 71) .....                             | 2    |
| 45                  | SC-018-11       | Mach. Screw 10-24 x $\frac{3}{8}$ Pan Hd. ....                  | 4    |
| 46                  | NS-027-03       | Nut - Crown 10-24 (Brass) .....                                 | 4    |
| 47                  | 00-811986-00005 | Tray - Grease (HGB 34) .....                                    | 2    |
| 48                  | 00-811986-00001 | Tray - Grease (HGB 50) .....                                    | 2    |
| 49                  | 00-811986-00002 | Tray - Grease (HGB 60) .....                                    | 2    |
| 50                  | 00-811986-00003 | Tray - Grease (HGB 71) .....                                    | 2    |
| 51                  | 00-811982-00003 | Burner Box Side Assy.(R.H.) .....                               | 1    |
| 52                  | 00-811982-00004 | Burner Box Side Assy.(L.H.) .....                               | 1    |
| 53                  | SD-022-48       | Self-Tapping Screw 10-16 x $\frac{1}{2}$ Pan Hd., Type AB ..... | 2    |
| 54                  | 00-812079       | Guide - Grease Tray .....                                       | 2    |
| 55                  | SD-022-48       | Self-Tapping Screw 10-16 x $\frac{1}{2}$ Pan Hd., Type AB ..... | 6    |
| 56                  | 00-811983-00005 | Back - Main (HGB 34) .....                                      | 1    |
| 57                  | 00-811983-00001 | Back - Main (HGB 50) .....                                      | 1    |
| 58                  | 00-811983-00002 | Back - Main (HGB 60) .....                                      | 1    |
| 59                  | 00-811983-00003 | Back - Main (HGB 71) .....                                      | 1    |
| 60                  | SD-022-48       | Self-Tapping Screw 10-16 x $\frac{1}{2}$ Pan Hd., Type AB ..... | 8    |

\*Note: Quantities listed are for model HGB34, unless otherwise noted.  
Quantities for other models may vary.

**RECOMMENDED SPARE PARTS**

| <b>PART<br/>NO.</b> | <b>NAME OF PART</b>              | <b>AMT.</b> |
|---------------------|----------------------------------|-------------|
| 00-412852-00001     | Grate - Top .....                | 2           |
| 00-408279-00012     | Regulator (Nat. Gas) .....       | 1           |
| 00-408279-00013     | Regulator (LP Gas) .....         | 1           |
| 00-410607-000G1     | Pilot Assembly .....             | 2           |
| 00-404738-00003     | Single Pilot Valve .....         | 2           |
| 00-812041-00001     | ON/OFF Burner Valve .....        | 2           |
| 00-410600-000G2     | Burner Assembly .....            | 2           |
| 00-410602-00001     | Burner Radiant (Cast Iron) ..... | 2           |
| 00-413157-00001     | ON/OFF Valve Handle .....        | 2           |