

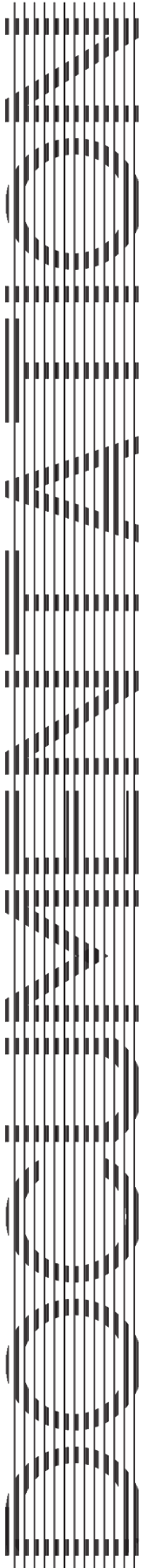

TECHNIQUE



INSTALLATION MANUAL
Condensing Hoods for Minijet combi

EN

1 - MANUTENTION

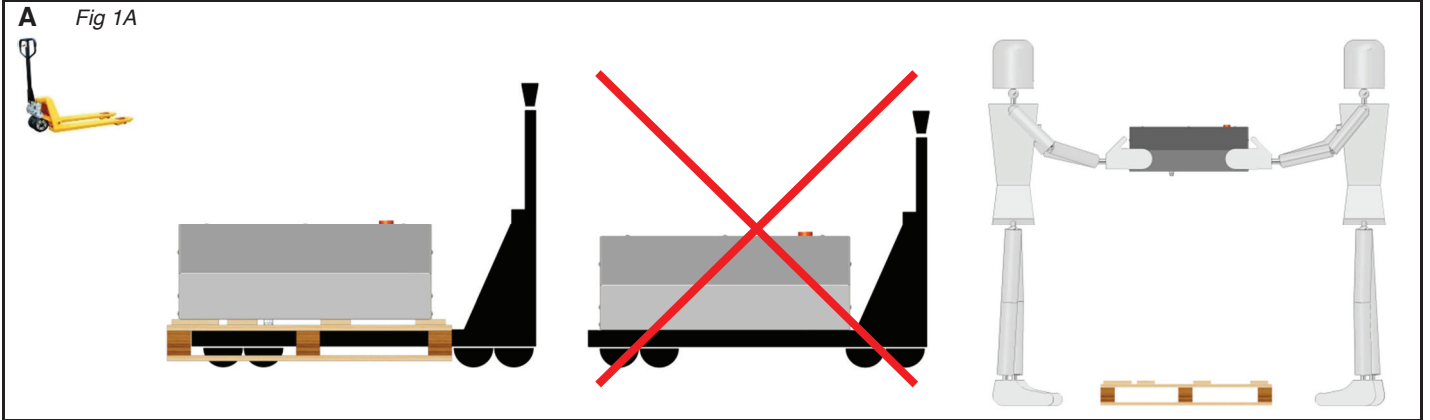

2 - LOCATING

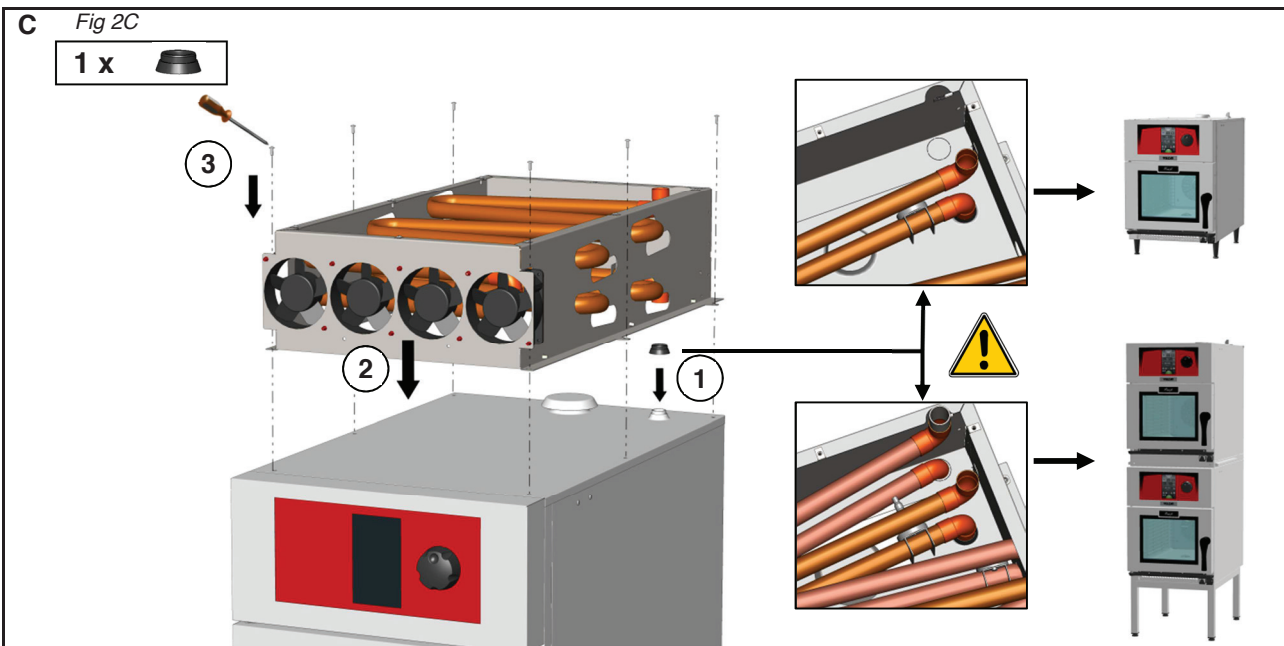
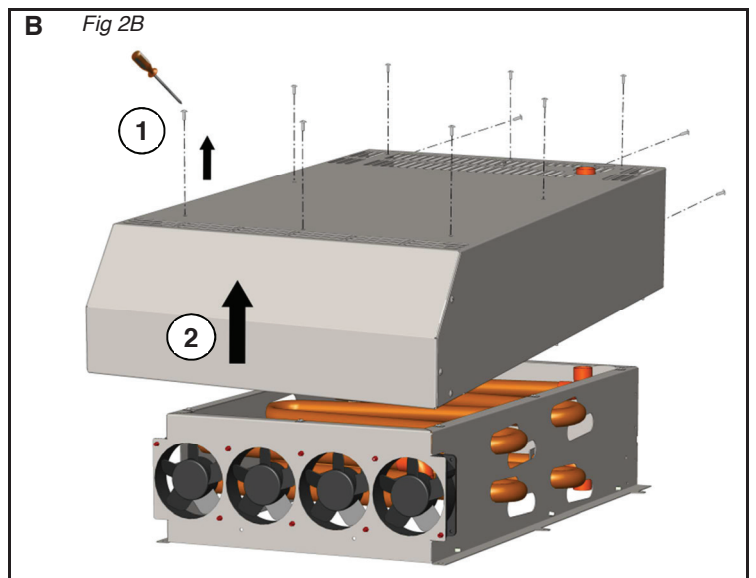
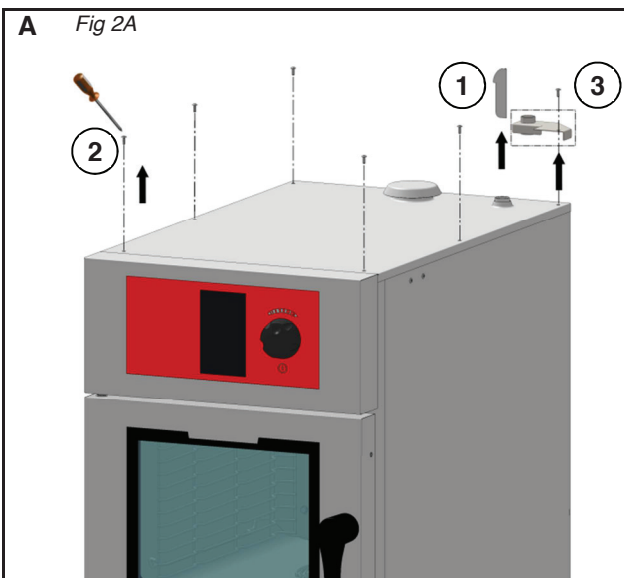

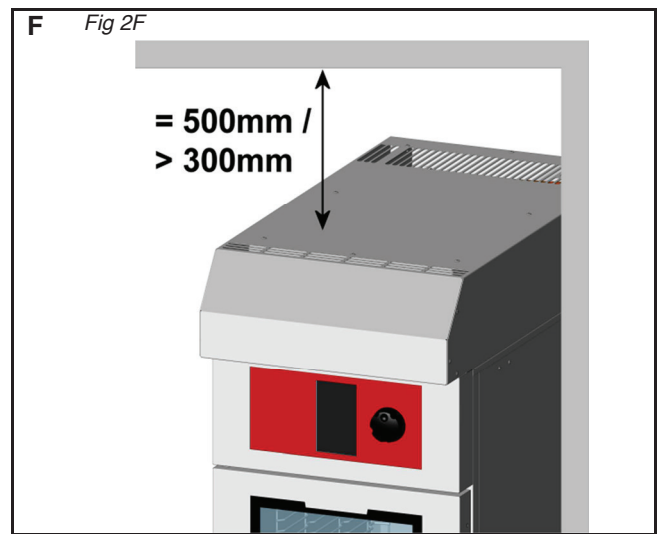
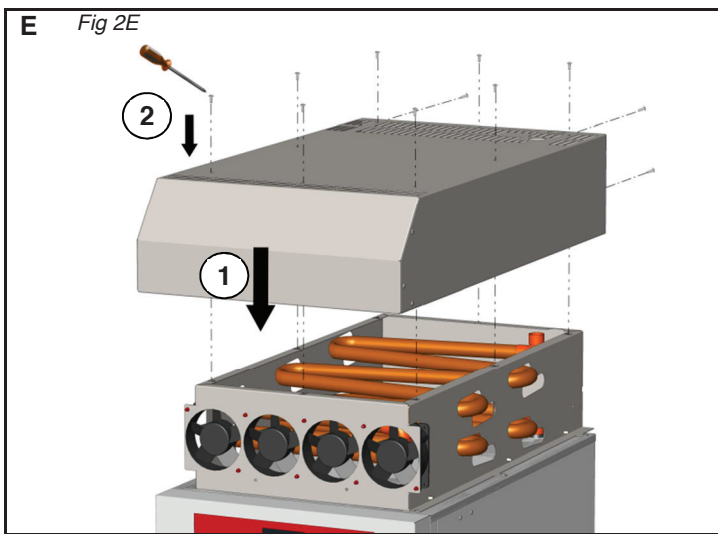
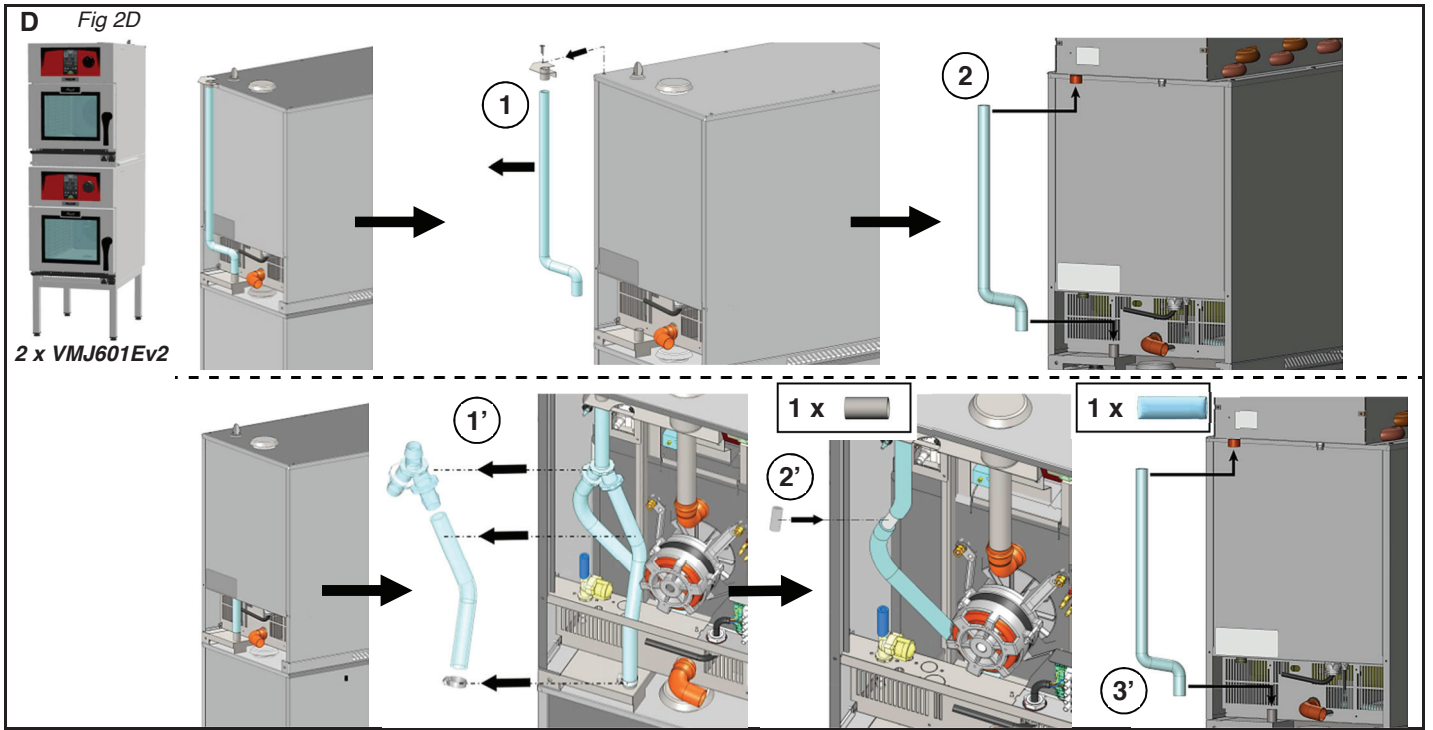

3 - ELECTRICAL CONNECTION

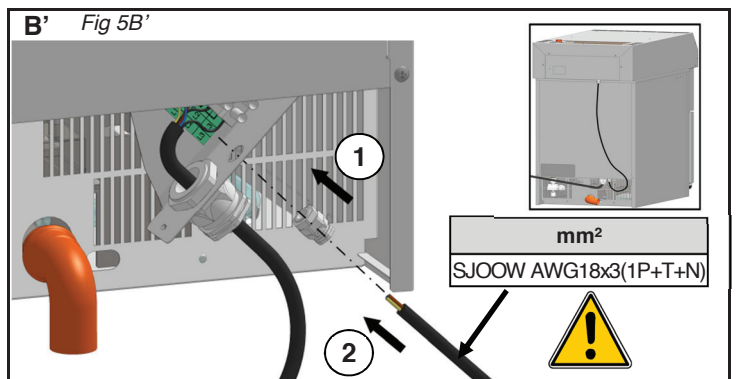
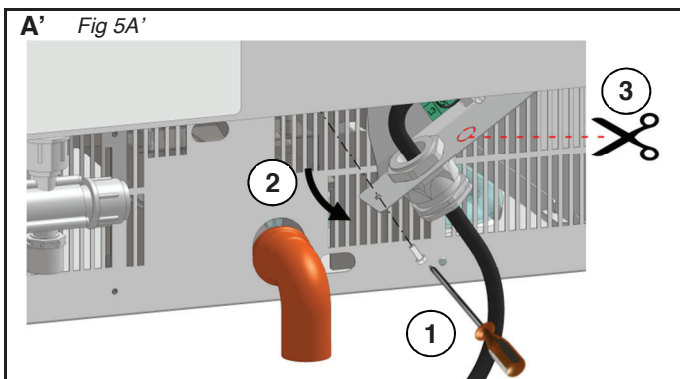

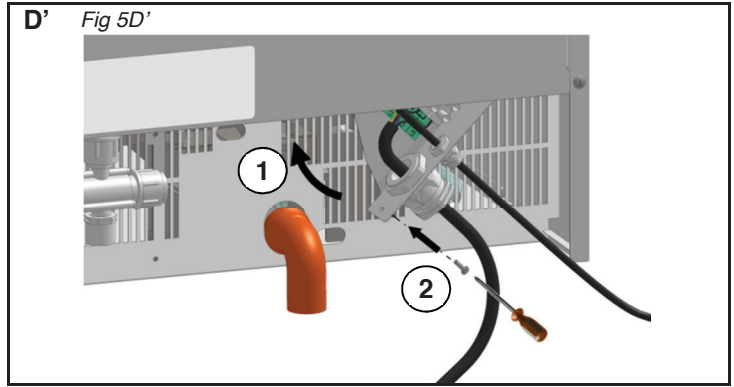
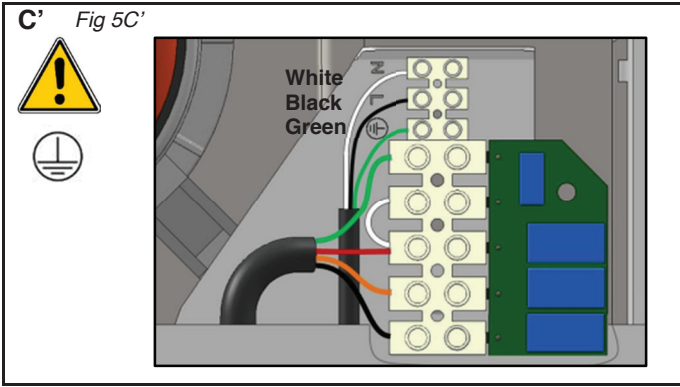

TECHNICAL CHARACTERISTICS

CODE	Designation	Energy	Weight (Kg)	Dimensions (inches)		
				Depth	Width	High
VACM6HCE	Accessory Mini 6 Condensation Hood (Elec)	Electric	32,00	37 5/8	20 3/4	9
VACM66HCE	Accessory Mini 6/6 Condensation Hood (Elec)	Electric	33,00	37 5/8	20 3/4	9

The balanced acoustic pressure level A is less than 70 dB(A).

DATA PLATE

In any correspondence about your equipment, please indicate:

- The model number
- The serial number
- The date

The data plate is located on the back of the hood.

Vulcan Hart Company
E75870 E146006

Famil. Art

Model.

Date Fab. Nr.

V A

kW Hz

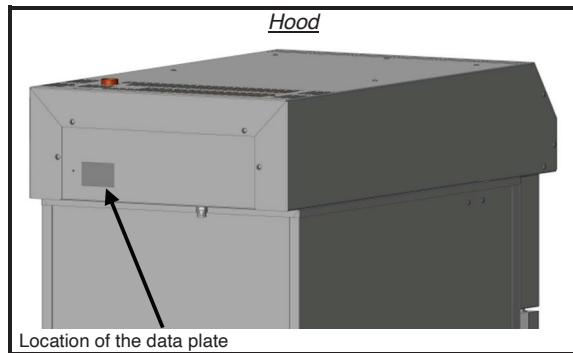

GENERAL REQUIREMENTS

● WARRANTY

To ensure the guarantee on this equipment, you should comply with the MANUFACTURER'S INSTRUCTIONS in this manual. However if you cannot undertake the required maintenance operations, our installation and service network is available to provide you with a personalized contract.

● WARNING

- The product delivered to you complies with current standards. If any modifications are made the manufacturer cannot accept any responsibility whatsoever. The manufacturer cannot be held responsible in the event of inappropriate use of the equipment.
- This equipment is intended for use by suitably trained professionals.
- When handling it, it is imperative to leave the appliance on its base till final installation.
- Read all the documentation before installation.
- Keep your documents for future reference.
- Translation of the original manual
- A qualified engineer must carry out the installation, modification or repair of the appliance in a workmanlike manner.
- The unit should be installed in a normally ventilated environment.
- The unit should be installed in a normally ventilated environment or having an air handling system that complies with current regulations.
- If these units are installed against a wall or a partition, this must be of non-combustible materials or, if not, it must be covered with an appropriate, good insulating and non-combustible material.
- It is vital that the minimum distance above the hood are respected if it is to function correctly:
 - Recommended = 500mm
 - Minimum = 300mm
- Unless specified otherwise, the parts protected by the manufacturer or his authorized representative must not be handled by the installer.
- The manufacturer certifies that the packaging meets the provision 94/62/CE (relating to packaging and packaging waste of 20.12.94) and requests that the final installer (or user) observes the rules relating to the removal of the packaging (recycling or reuse).
- Always comply with current local regulations regarding connecting the unit to water, electricity and drainage.
- ATTENTION – Disconnect electrically before any form of maintenance.
- The manufacturer disclaims any liability in the event that the above instructions are not followed.
- The appliance should only be handled with suitable lifting equipment. Should the appliance need to be transported, this must be on its original pallet and it must not be stacked on other appliances under any circumstances. If the appliance is to be moved without its pallet, it should be carried and not pulled. *Fig. 1A*

LOCATION

Place the hood on top of the VULCAN oven, the holes in the left and right hand fixing plates should align with the holes in the oven top panel.

Fig. 2A-F

Condensation goes directly to drain through the oven(s). *Fig. 2D-D'*

Connect the copper serpentine(s) to the oven chimney: locate the copper elbow onto the oven chimney outlet tube. *Fig. 2C*

CONNECTIONS

ELECTRICAL CONNECTION

The fixed electrical supply to the unit must incorporate an appropriate isolator that can be locked in the off position.

All aspects of the installation should be in compliance with current local regulations. The appliance must be connected to earth.

These instructions include recommendations concerning the characteristics and the type of additional protective devices that may need to be installed, potentially one or several residual current devices.

- Only use the SJOOW supply cable provided with the hood.

Electrical connection is to the rear of the oven *Fig. 3A-D'*

- Undo the fixing screws for the terminal support plate
- Tilt it to the left.
- Located the cable gland supplied
- Feed the cable through the cable gland.
- Connect the cables (ensure Neutral and Earth are correct).
- Tighten the cable gland.
- Refit the plate.

Provide an approved omnipolar isolation device, (with at least 3 mm clearance between the contacts).



VULCAN

A division of ITW Food Equipment Group LLC

P.O. Box 696

Louisville, KY 40201